

WE MAKE RIDERS

CHICOUTIMI, QUÉBEC



TECHNICAL MANUAL

TROYST 2025+

DEVINCI



ABOUT OUR MANUALS

Like many sports, cycling involves risk of injury and accidents, so you must be fully aware of these risks. Neither the manufacturer, the retailer, nor the person who sold you the bike, nor the people who maintain the trails are responsible for these risks. As you are solely responsible, it is, therefore, essential that you read and fully understand all the parts contained in this manual.

To enjoy maximum safety and enjoyment right from the get go, it is important that you are familiar with your new bike, its handling and its possibilities. It is your duty to maintain your bike well and reduce the risk of injury. Biking can be a dangerous activity, even under the best conditions. These are risks associated with using a bicycle that cannot be predicted or avoided. These are the sole responsibility of the cyclist.

YOUR AUTHORIZED DEVINCI RETAILER

Your authorized Devinci retailer is at your service to guide your choices of bike and accessories which are best suited to the style of biking you wish to perform. This will help you maintain your equipment in good condition so that you can take full advantage of your investment. The staff at your authorized Devinci retailer have the training, experience and tools to carry out the repairs and provide you with reliable advice.

However, your authorized Devinci retailer cannot make decisions for you, and cannot be held responsible for your lack of knowledge, experience, qualification or common sense. However, it will take the necessary time to explain the operation of a component or to help you choose an accessory that meets your specific needs.

For further information, please see the Devinci's User Manual available on www.Devinci.com or ask your authorized Devinci retailer. He will take the time to answer any questions you may have and will advise you with great pleasure.



TABLE OF CONTENTS

FRAME: TECHNICAL SPECIFICATIONS	4
CABLE ROUTING	8
SERVICE KITS	18
DEVINCI'S RIDE IN PEACE WARRANTY	28



FRAME

TECHNICAL SPECIFICATIONS



FORK TRAVEL ALTERATION



The Devinci Troy Gen-5 is specifically designed and tested for use with a 160 mm travel front suspension fork. Any modifications to the fork travel or style, including but not limited to a 170 mm travel fork, are not recommended and will void the original frame warranty.

The maximum allowable axle-to-crown length for the Devinci Troy Gen-5 is 576 mm. Exceeding this measurement may compromise the bike's performance and safety, potentially leading to catastrophic frame failure and serious personal injury.



SUSPENSION SET UP

Suspension specialist in your pocket!

The RockShox TrailHead app is a starting point for dialing in your suspension settings, ensuring a perfect ride experience.

WEB: [GET STARTED](#)

APPLE STORE: [DOWNLOAD THE APP](#)

GOOGLE STORE: [DOWNLOAD THE APP](#)

HEADTUBE DIMENSIONS		
1. UPPER (S.H.I.S)	ZS44	1-1/8" Zerostack
2. LOWER (S.H.I.S)	ZS56	1.5" Zerostack
BOTTOM BRACKET		
3. STANDARD	BSA 73	
4. ISCG MOUNT	ISCG 05 3 tabs	
5. MINIMUM Q FACTOR	168	
MECHANICAL DRIVETRAIN		
6. REAR HUB SPACING (OVER LOCKNUT DIMENSION)	TA 12x148 Boost	
7. MAX & MIN CHAINRING	34T	28T
8. SMALLEST COG COMPATIBLE	12s 9T	
9. BIGGEST COG COMPATIBLE	12s 52T	
10. RECOMMENDED CHAINLINE	55mm	
SEATPOST & SEATCLAMP		
11. SEAT TUBE INSIDE DIAMETER (ID)	31.6 mm	
12. SEAT TUBE OUTSIDE DIAMETER (OD)	35 mm	
13. DROPPER POST COMPATIBLE	YES Fully internal	
BRAKES		
14. BRAKE MOUNT (FRAME)	Post-Mount 200 mm direct	
15. MAX ROTOR SIZE AVAILABLE (FRAME)	220 mm	
ACCESSORIES		
16. WATER BOTTLE (FRAME)	YES (16 OZ.)	
17. STORAGE SYSTEM	YES SHED	
18. PROTECTORS	DOWNTUBE & CHAINSTAY	
GEOMETRY INPUTS (BASED ON MEDIUM SIZE WITH 29" WHEELS)		
TROY FORK 140 MM TRAVEL 130MM		
19. FRONT SUSPENSION (TRAVEL & SAG)	140 mm	25%
20. REAR SUSPENSION (TRAVEL & SAG)	130 mm	30%
21. FORK (AXLE-TO-CROWN [A] & OFFSET [B])	A. 551 (533 XS-S)	B. 44 (37 XS-S)
22. FRONT & REAR WHEEL GEOMETRY	750 (710 XS-S)	
23. FRONT & REAR WHEEL MAX ETRTO	63-622 (63-584 XS-S)	63-622 (63-584 XS-S)
24. REAR SUSPENSION (DIMENSIONS & SAG)	185 x 47.5 mm	30%
25. PIGGYBACK SHOCK COMPATIBILITY	YES	
26. SPRING TYPE COMPATIBILITY	Air & Coil	
27. REAR SHOCK ORIENTATION	FORWARD UP	
28. UPPER (OR FRONT) SHOCK HARDWARE DIMENSION	Trunnion	
29. LOWER (OR REAR) SHOCK HARDWARE DIMENSION	40 x 10 mm	
30. REAR TIRE CLEARANCE*	27,5" x 2.6" / 29" x 2.5"	

* **DISCLAIMER:** We are testing many different tires to establish a clearance number that cover a wide spectrum of tires with appropriate frame clearance. However, it is impossible for us to test all tires and rim combination available on the market, so be mindful that some combinations may result in slight rubbing if higher than 66mm in actual width.

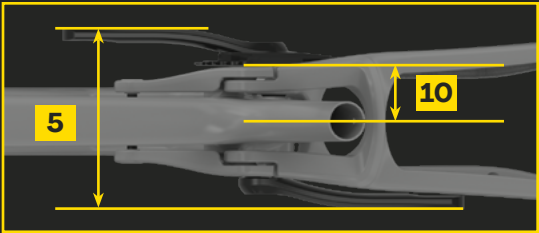

SIZES AVAILABLE

XS | S | M | L | XL



13

MAX INSERTION LENGTH
XS: 235MM
S: 265mm
M: 280mm
L: 305mm
XL: 330mm

1

2

19

22

23

11

12

16

17

24

20

18

4

3

18

6

7

15

8

9

14

21A

21B

22

23

1

2

←

CLIC!

→

X

✓

i

THE STORAGE DOOR MUST BE PROPERLY ENGAGED TO ENSURE ITS ATTACHMENT AT THE DOWNTUBE LEVEL.

A "CLICK" WILL ACCOMPANY THE CLOSURE WHEN THE DOOR IS SECURELY LOCKED ONTO THE INNER SURFACE OF THE DOWNTUBE.

MAKE SURE THE LATCH IS CORRECTLY PRESSED BEFORE EACH RIDE (ACCORDING TO IMAGE 2).

FRAME → TECHNICAL SPECIFICATION_PLAN

7

CABLE ROUTING

CABLE ROUTING

BEFORE STARTING

SHIFT AND BRAKE HOUSING GUIDES

Make sure the guides are in place before you start routing the cables inside the frame. If they are not already in place, follow these steps before you begin:

- STEP 1** | *To orient the guide correctly through the downtube, take a 5mm housing and insert it into the guide.*
- STEP 2** | *Insert the guide with the housing inside through the opening at the bottom of the seat tube, above the bottom bracket.*
- STEP 3** | *Secure the outer part of the guide to the seat tube using the small screw to lock the guide's position on the frame. Repeat the steps for the other side.*

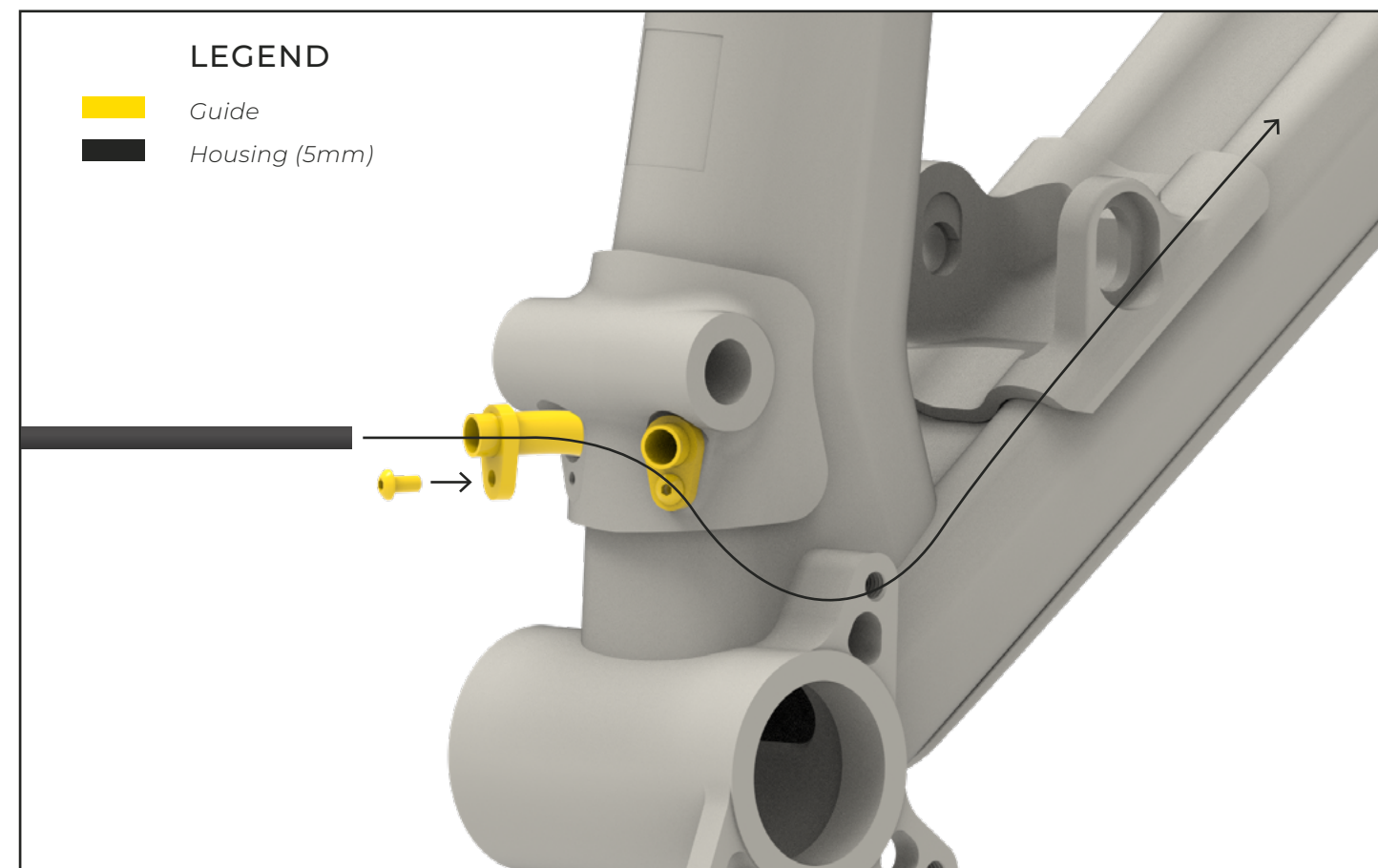

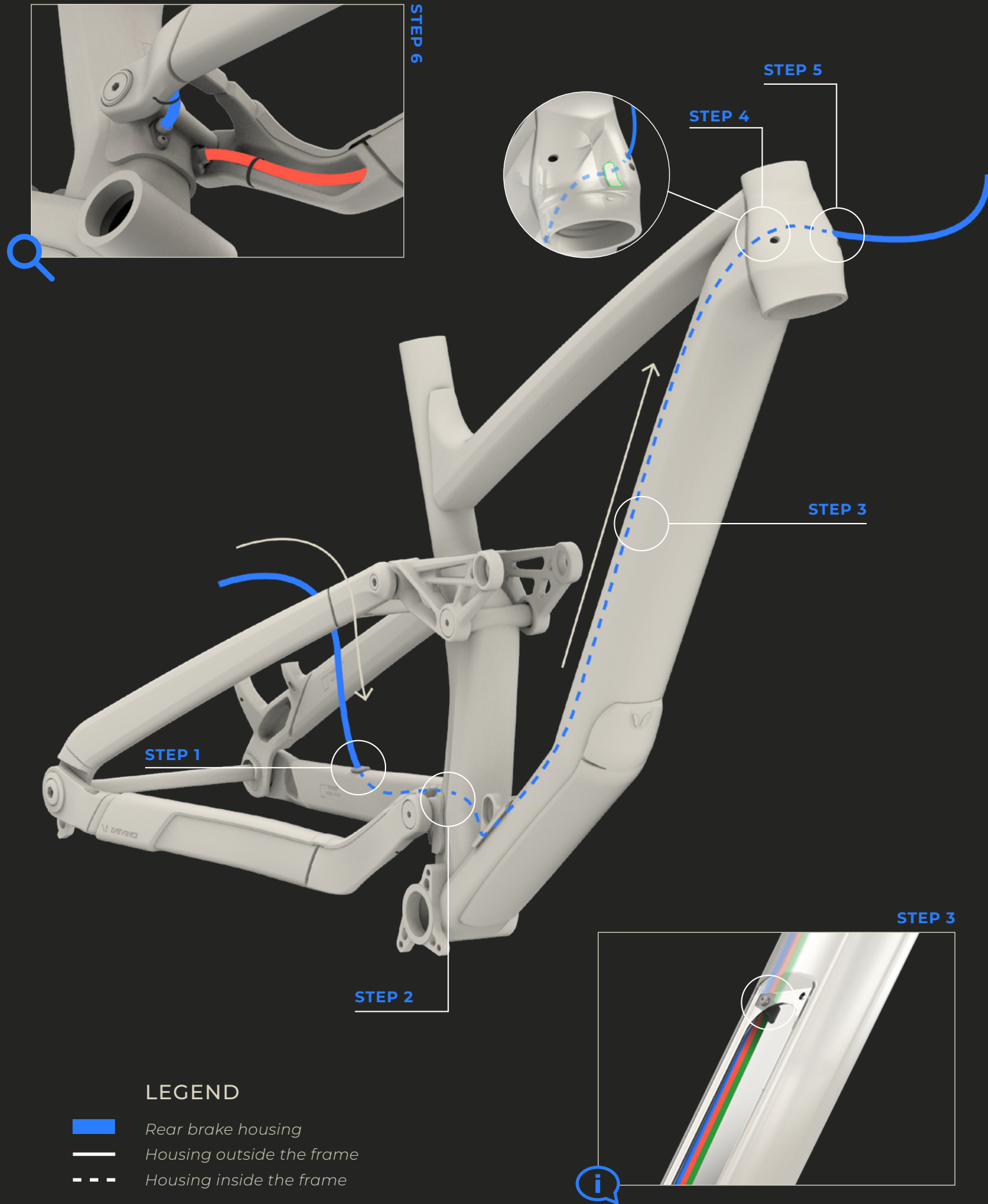

CABLE ROUTING

REAR BRAKE HOUSING

- STEP 1** | Introduce the rear brake housing through the rubber grommet located on the top of the base, on the left side, and route it to the opening at the front.
 - STEP 2** | Insert the rear brake housing into the diagonal through the left guide located at the bottom of the seat tube.
 - STEP 3** | Slide the housing on the left side into the diagonal until it reaches the head tube, securing it against the inner surface of the diagonal using the provided clips.
 - STEP 4** | Insert the rear brake housing into the left inner oval opening of the head tube.
 - STEP 5** | Pull the housing out through the upper left opening located on the head tube.
 - STEP 6** | Secure the rear brake housing at the chainstay in the designated spot using a small zip tie.
- i** Ensure that the rear brake housing is properly inserted into the left inner cavity of the head tube to prevent rubbing against the fork's steerer tube.
- i** Make sure to properly complete the last step to avoid the risk of rubbing between the housing and the tire.

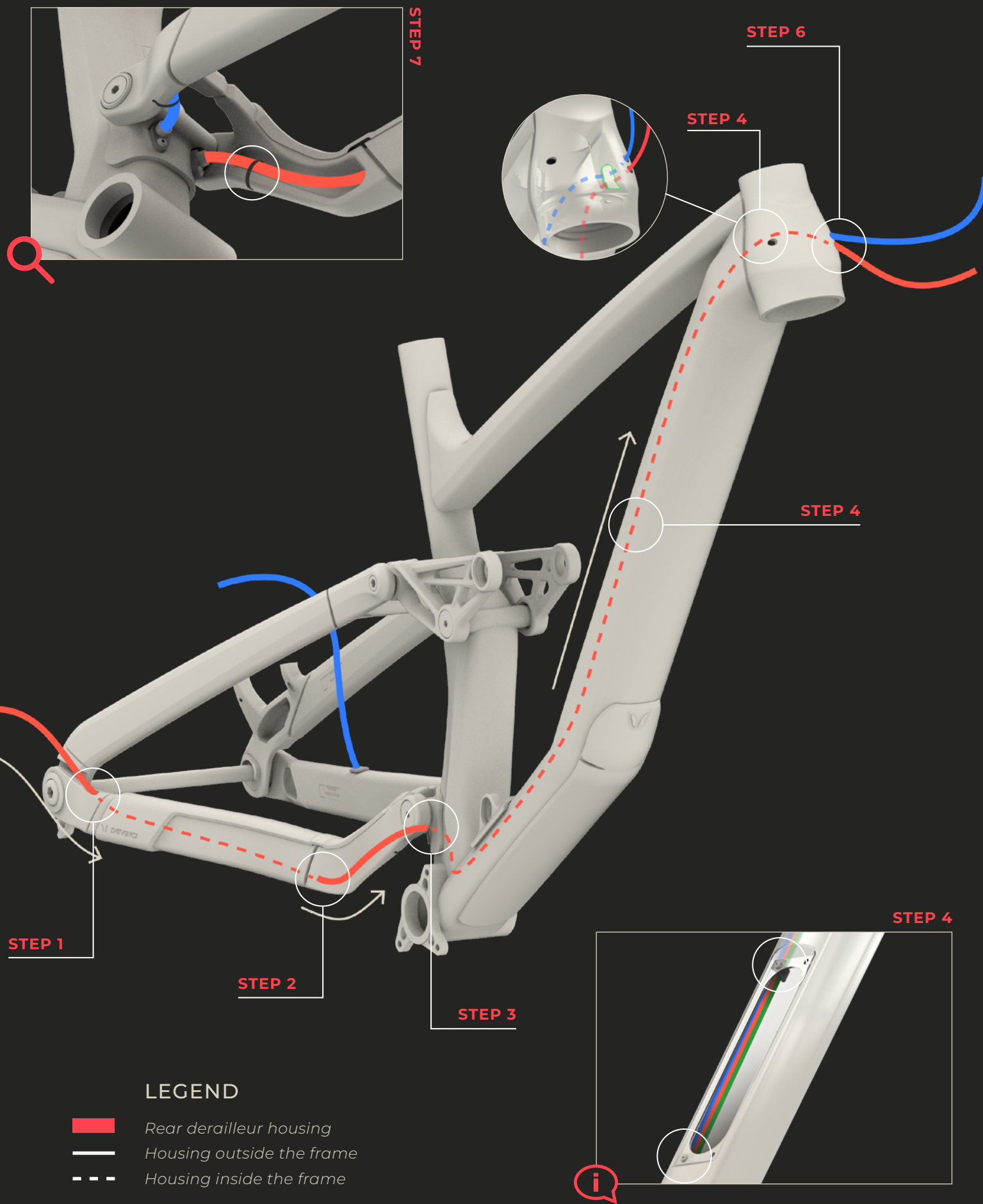

CABLE ROUTING

REAR DERAILLEUR HOUSING

i Tip → Slightly bend the end of the housing to facilitate its insertion into the base before starting.

STEP 1 | Insert the rear shift housing through the opening located on the upper surface of the base.

STEP 2 | Route the housing through the base on the right side and pull it out through the opening located on the inner surface at the front of the base.

STEP 3 | Insert the housing into the diagonal through the right guide located at the bottom of the seat tube.

STEP 4 | Slide the housing to the left into the diagonal until it reaches the head tube, securing it against the inner surface of the diagonal using the provided clips.

STEP 5 | Insert the rear brake housing into the left inner oval opening of the head tube.

i Ensure that the rear brake housing is properly inserted into the left inner cavity of the head tube to prevent rubbing against the fork's steerer tube.

STEP 5 | Pull the housing out through the lower left opening located at the front of the head tube.

STEP 6 | Secure the rear shift housing at the base in the designated spot using a small zip tie.

i Make sure to properly complete the last step to avoid the risk of rubbing between the housing and the tire.

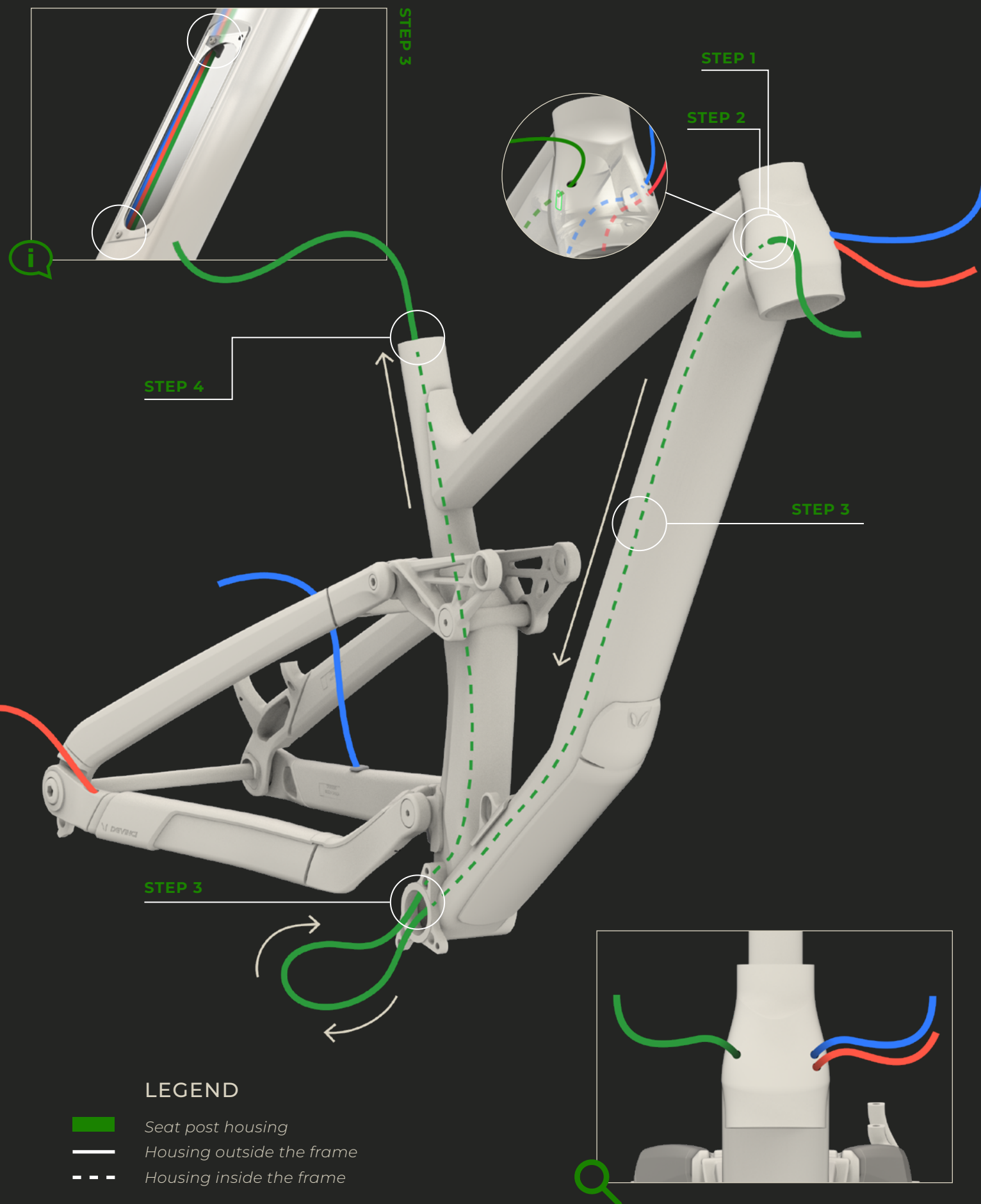

CABLE ROUTING

SEAT POST HOUSING

STEP 1 | Insert the seat post housing into the head tube through the opening located on the right side.

STEP 2 | Insert the seat post housing into the right inner oval opening of the head tube.

i Ensure that the seat post housing is properly inserted into the right inner cavity of the head tube to prevent rubbing against the fork's steerer tube.

STEP 3 | Slide the housing to the left into the diagonal until it reaches the bottom bracket, securing it against the inner surface of the diagonal using the provided clips.





STEP 4 | Pull the housing out of the frame through the bottom bracket. Create a loop with the housing to facilitate its reinsertion.

STEP 5 | From the bottom bracket, insert the housing into the seat tube until it reaches the other end of the tube.

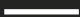

CABLE ROUTING OVERVIEW

LEGEND

-  Rear brake housing
-  Rear derailleur housing
-  Seat post housing
-  Routing outside the frame
-  Routing inside the frame

Ensure that the housings are parallel to each other to avoid interfering with the proper functioning of the housings and the smooth sliding of the bag inside the diagonal tube.

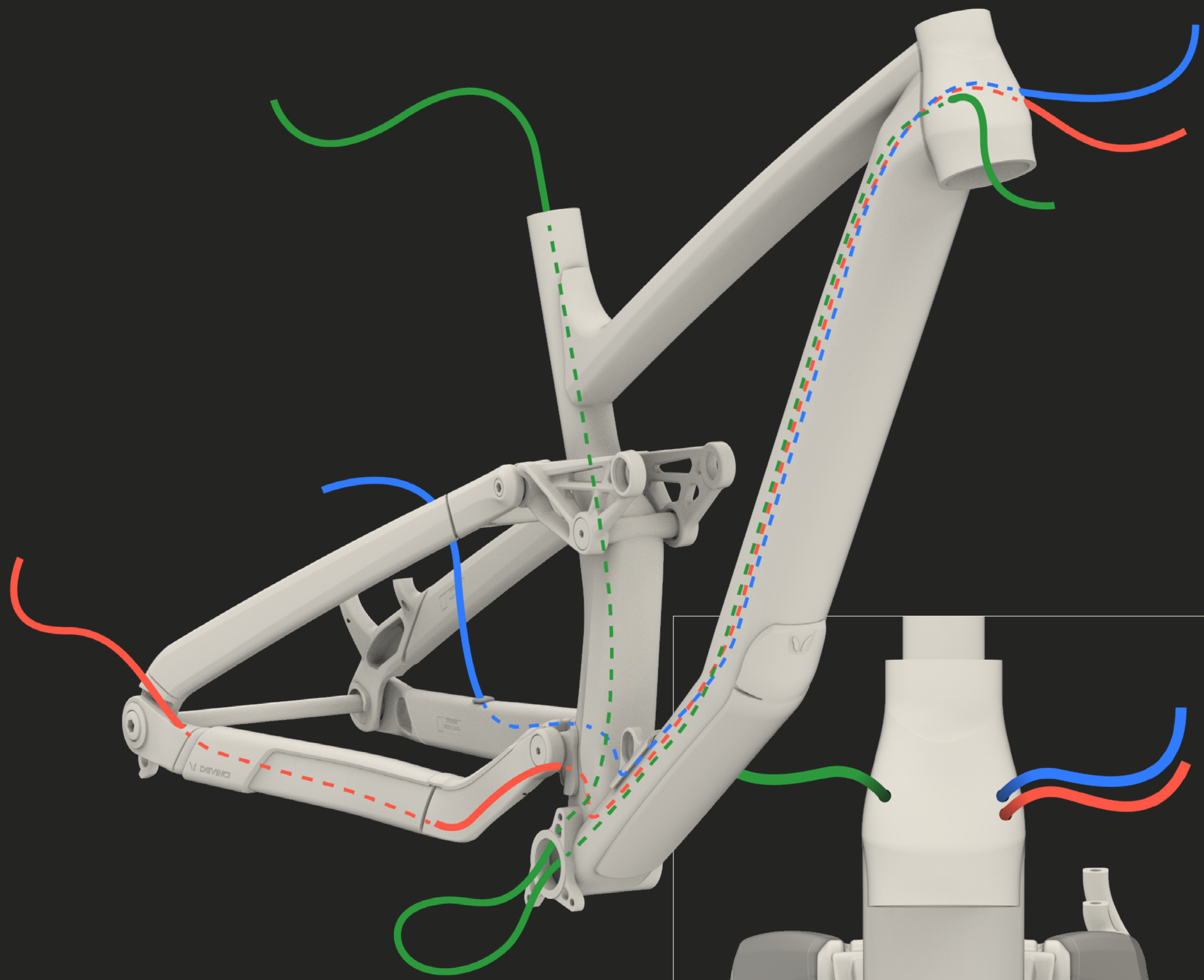

A close-up photograph of a bicycle's front fork assembly, specifically the Rock Shox air fork. The image is dark and moody, with the text 'SERVICE KITS' overlaid in white. The Rock Shox logo is visible on the lower part of the fork. The text '360 MAX psi' is also visible on the upper part of the fork. The text 'SERVICE KITS' is written in a bold, sans-serif font.

SERVICE KITS

KFC08902 | BALL BEARING KIT TROY/TROYST

ITEMS	PART #	DESCRIPTION	QTY
1	MFP21016	BALL BEARING MR20307 20x30x7; STD TYPE, DOUBLE LIP	2
2	MFP24014	BEARING 6900 WITH EXTENDED INNER CAGE	2
3	MFP19001	BALL BEARING 3801 LLU MAX 12x21x8	6

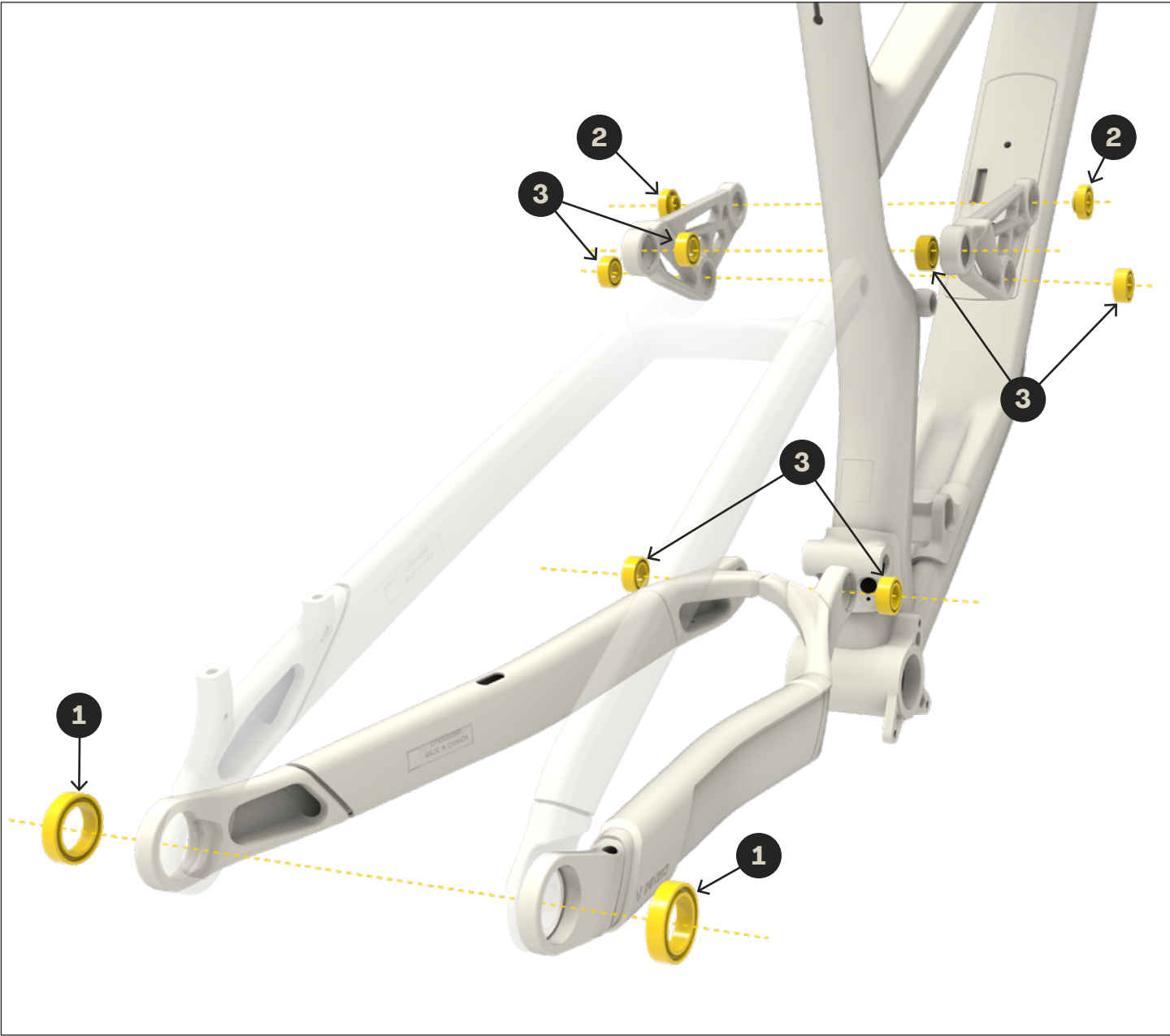

KFC09001 | SHOCK BOLT KIT TROY/TROYST

ITEMS	PART #	DESCRIPTION	QTY
1	MFV24009	SOCKET CAP SCREW M10x1.0 X 16mm	2
2	MFP25008	ADJUSTER 5.5mm FOR 10mm SCREW	1
3	MFP25009	ADJUSTER 5.5mm M10x1.0	1
4	MFV25001	SOCKET CAP SCREW M10x1.0 X 59	1

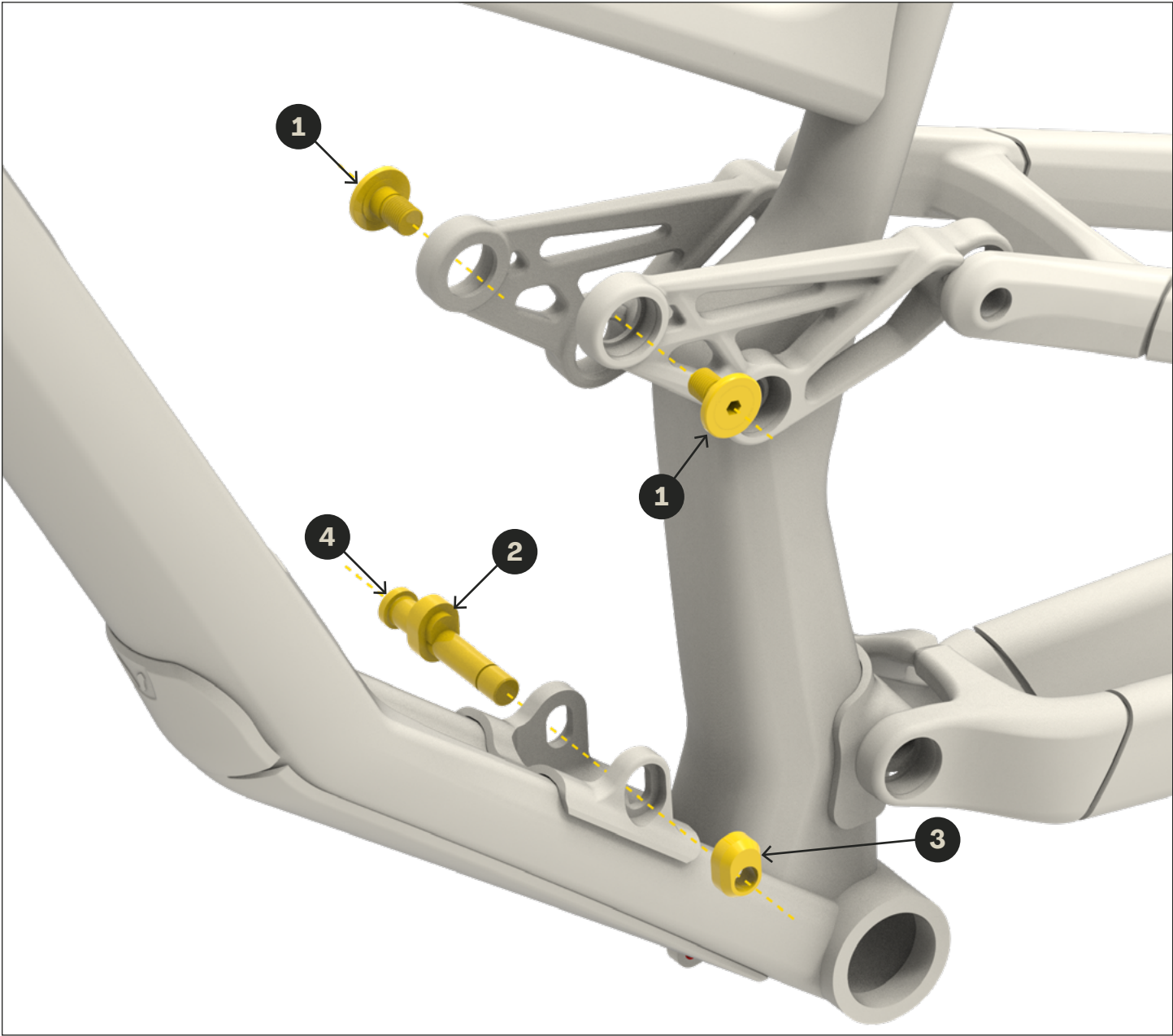

ITEMS	PART #	DESCRIPTION	QTY
1	MFP24008	Split pivot NDS shaft 20mm	1
2	MFD21001	HANGER UDH	1
3	MFP24009	Nut for 20mm split pivot shaft	1
4	MFV24016	Pivot screw M12 x1.0 x 21mm	2
5	MFV24008	Washer for pivot Emtb-SL	2
6	MFV24012	Socket flat screw M8x1.25 X 20mm, SS blk	2
7	MFP24010	Linkage Pivot shaft Emtb-SL	2
8	MFP24012	CS pivot spacer Emtb-SL	2

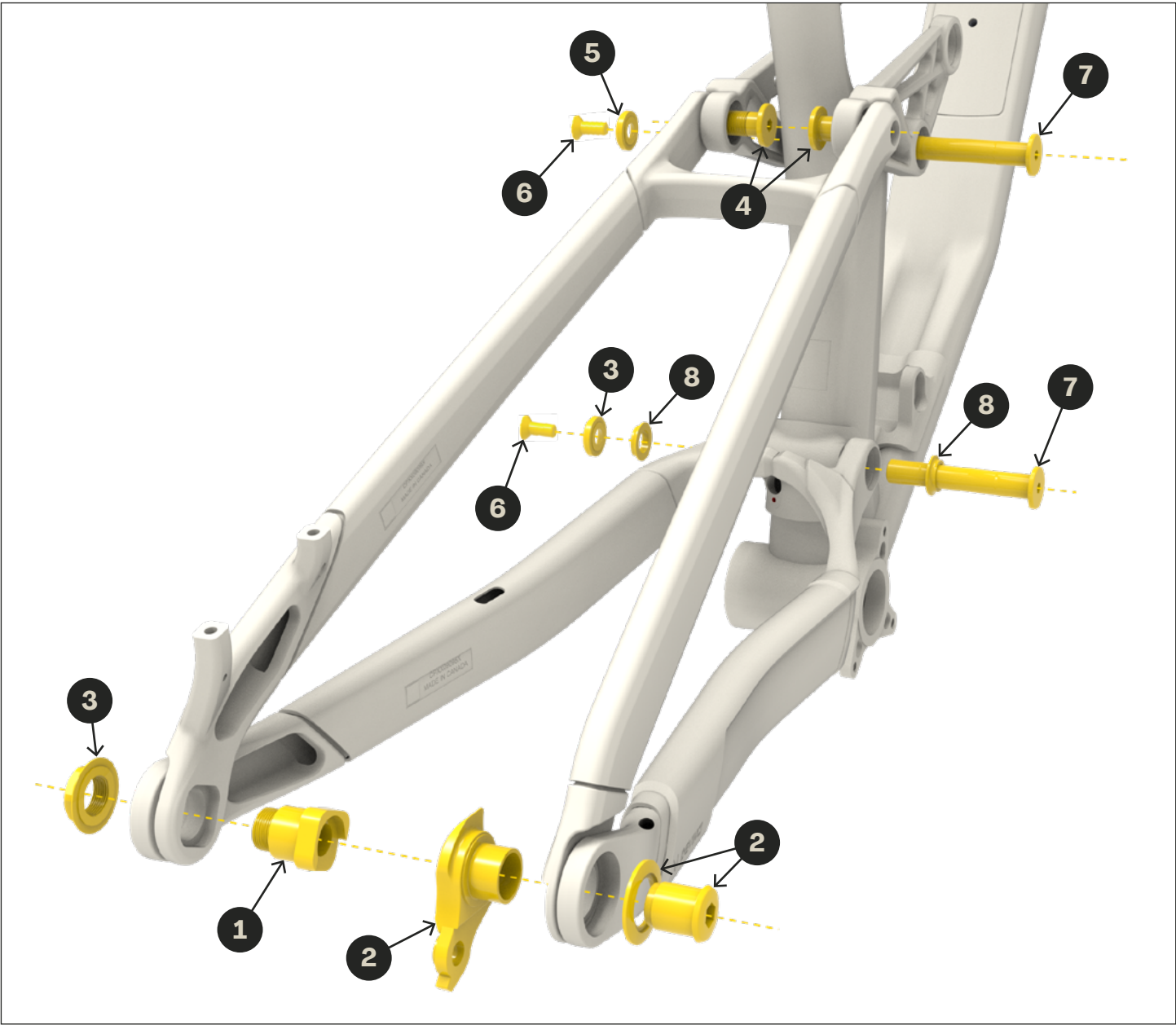

ITEMS	PART #	DESCRIPTION	QTY
1	MFB19008	CABLE GUIDE 5mm	1
2	MFB25001	CABLE GUIDE FOR 081-090	2
3	MFV23016	ALLEN BUTTON SCREW M3x0.5 X 6mm	2

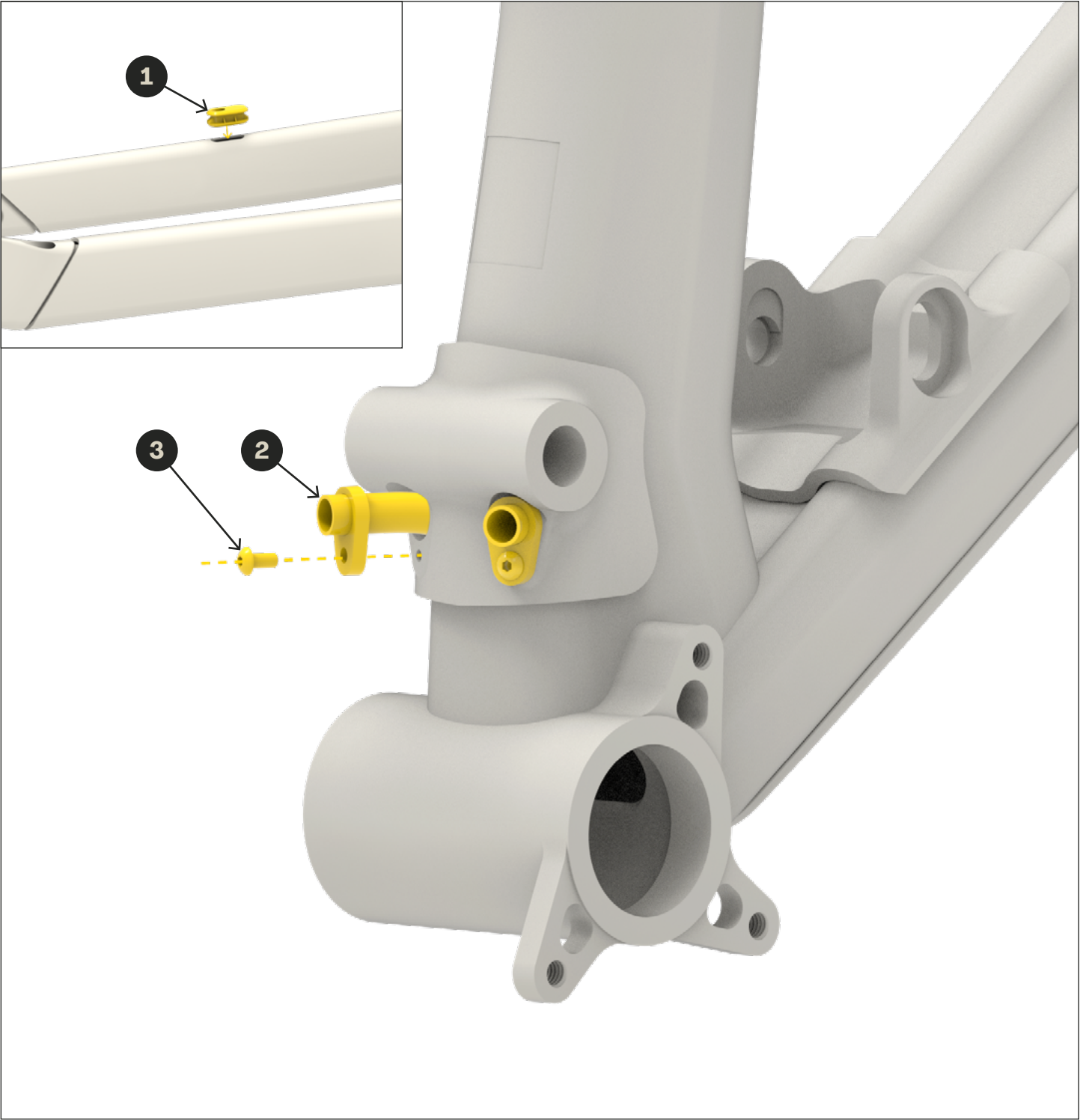

KFC09004 | CHAINSTAY PROTECTOR TROY/TROYST

ITEMS	PART #	DESCRIPTION	QTY
1	MACP25001	CHAINSTAY PROTECTOR 090-9800	1

KFC09005 | DOWN TUBE PROTECTOR TROY/TROYST

ITEMS	PART #	DESCRIPTION	QTY
2	MACP25002	DT PROTECTOR 081-090	1

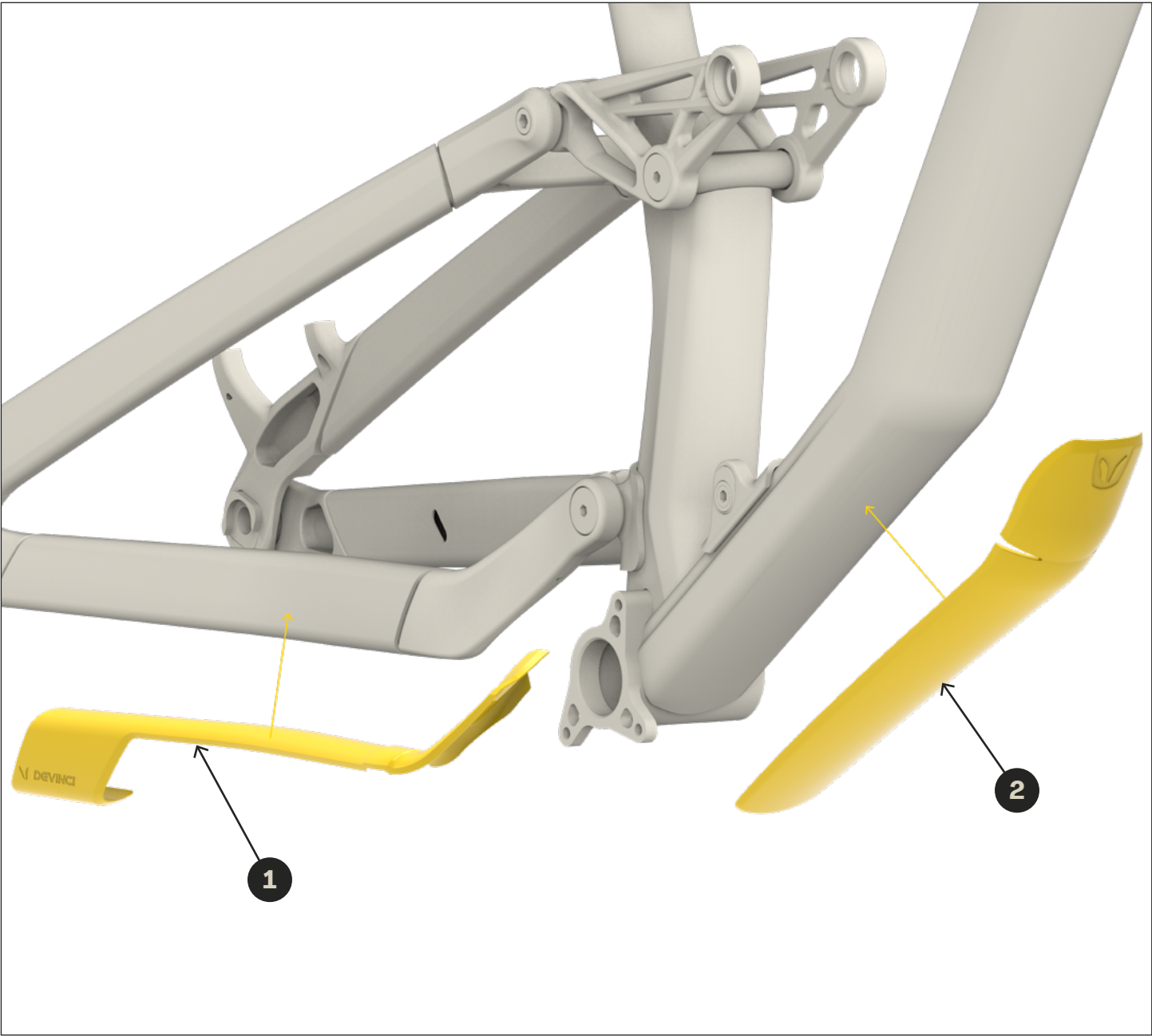

KFC09006 | 'SHED' STORAGE ASSEMBLY



ITEMS	PART #	DESCRIPTION	QTY
1	MPAC24001	PORTE DE RANGEMENT ASSEMBLÉE	1
1.1	MFP24027	SYSTEM DOOR	1
1.2	MFP24028	MECANISM COVER	1
1.3	MFP24029	SYSTEM LOCK	1
1.4	MFV097132	FLAT HEAD THREAD FORMING SCREW FOR PLASTIC, #4 X 3/8"	2
1.5	MFV07003-01	ALLEN BUTTON SCREW M5x0.8 X 12	2
1.6	MFP24030	SYSTEM SEAL	1

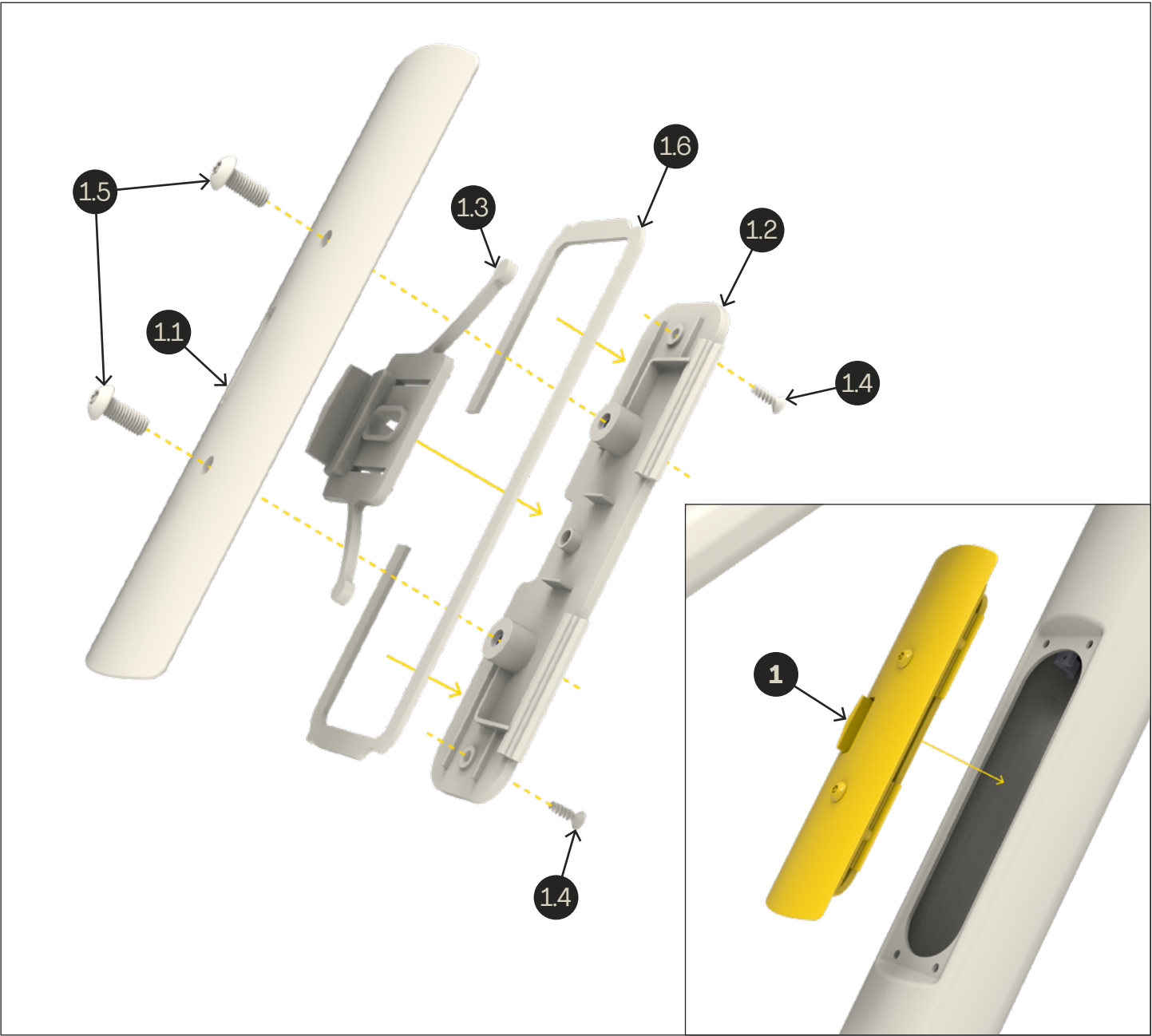

KFC05602 | DERAILLEUR HANGER UDH

ITEMS	PART #	DESCRIPTION	QTY
1	MFP21001	RD Hanger UDH	1

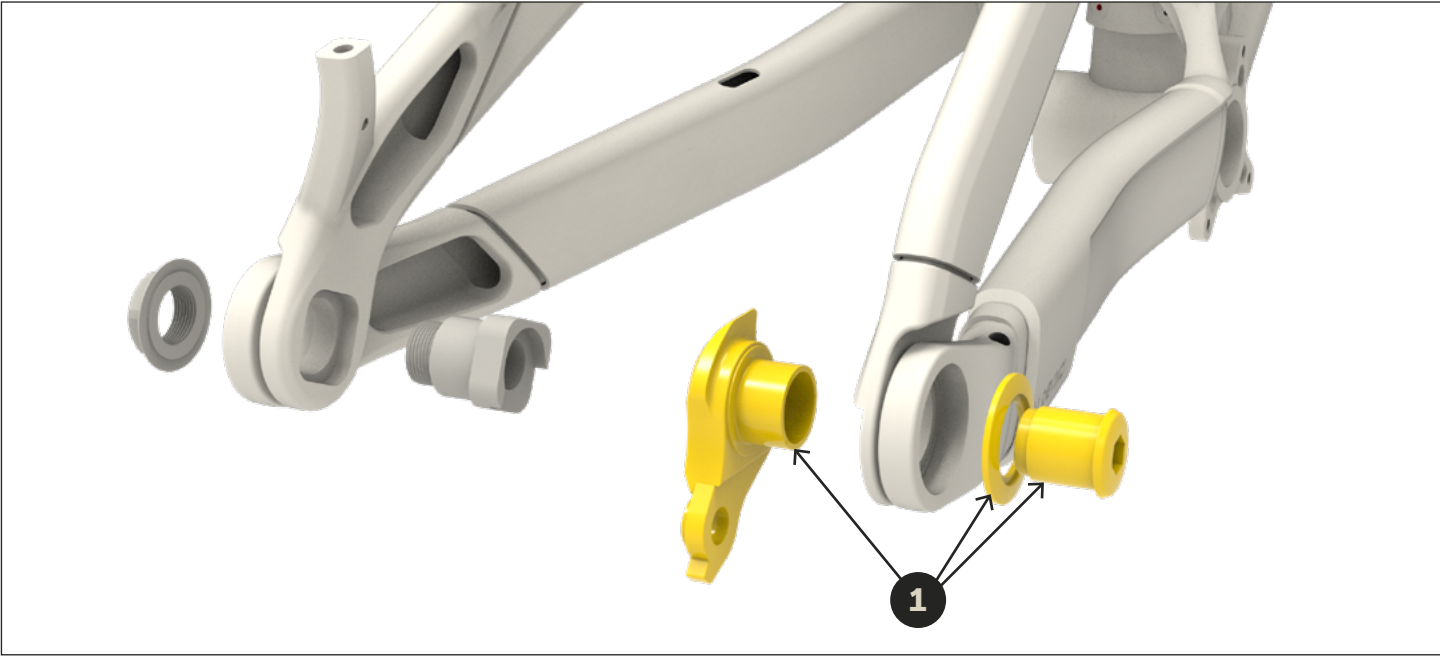

KFC06503 | REAR AXLE BOOST 148 12MM UDH

ITEMS	PART #	DESCRIPTION	QTY
2	MATAR23002	Rear axle for 148mm UDH	1

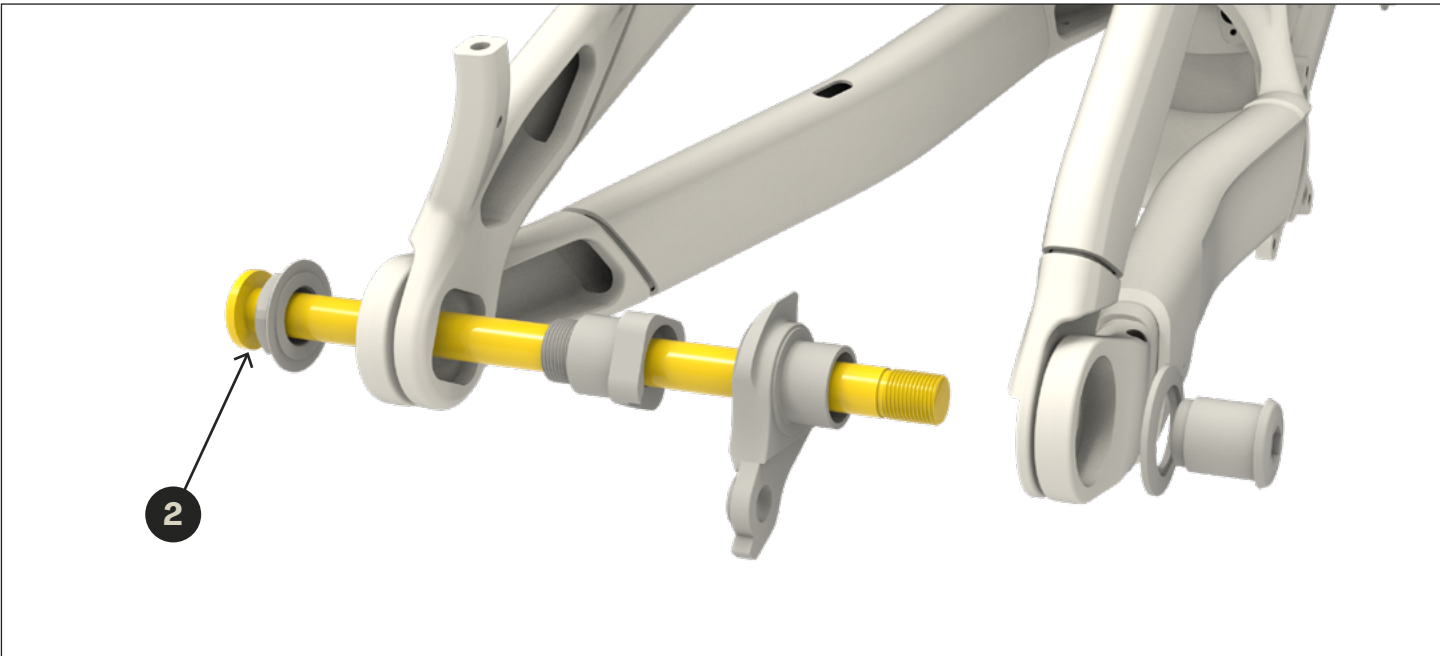

KFC09007 | TOOL BAG FOR SHED STORAGE



ITEMS	PART #	DESCRIPTION	QTY
1	MFP24031	Tool bag	1



ITEMS	PART #	DESCRIPTION	QTY
1	MFP24026	Aluminium frame SHED spacer	1

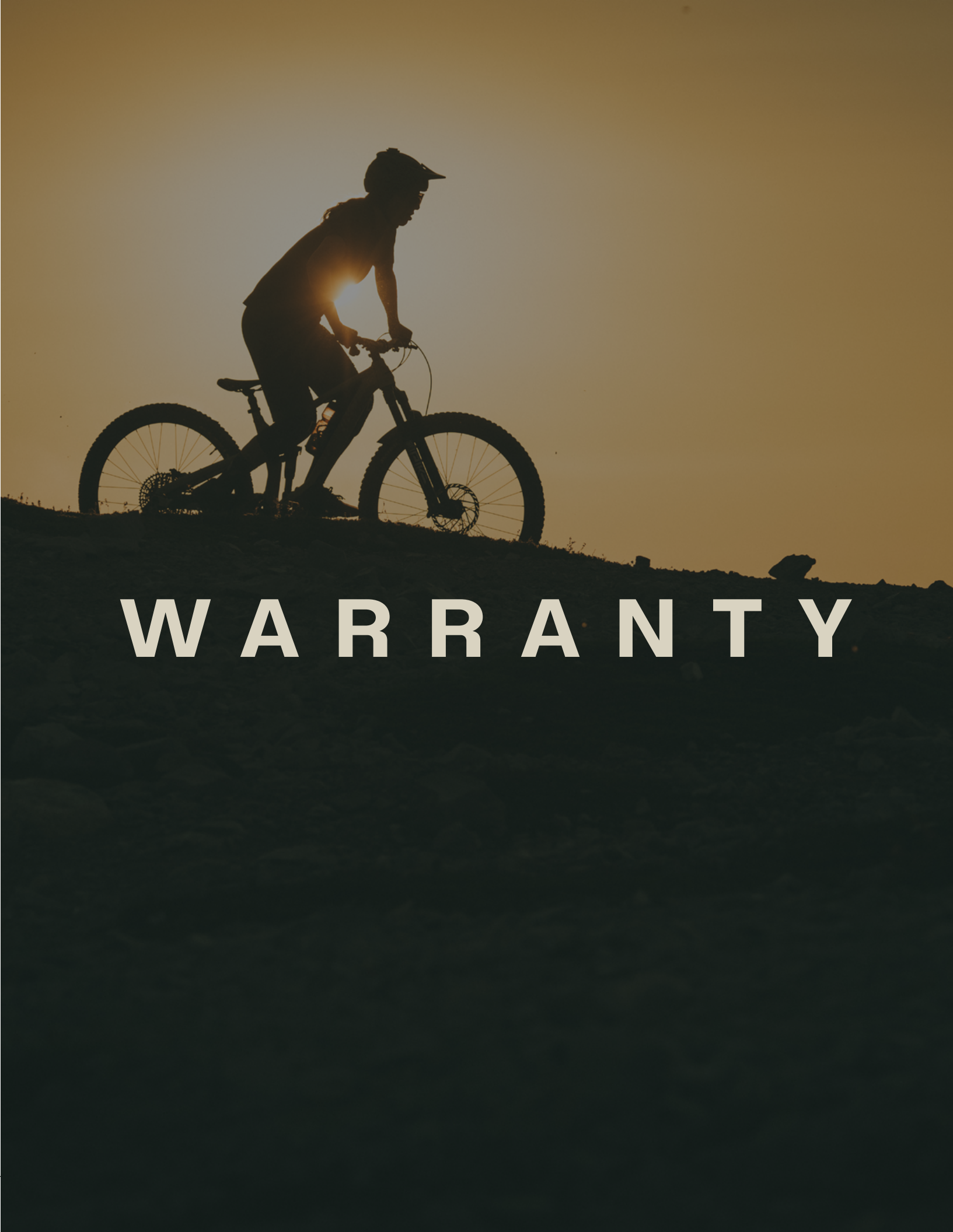
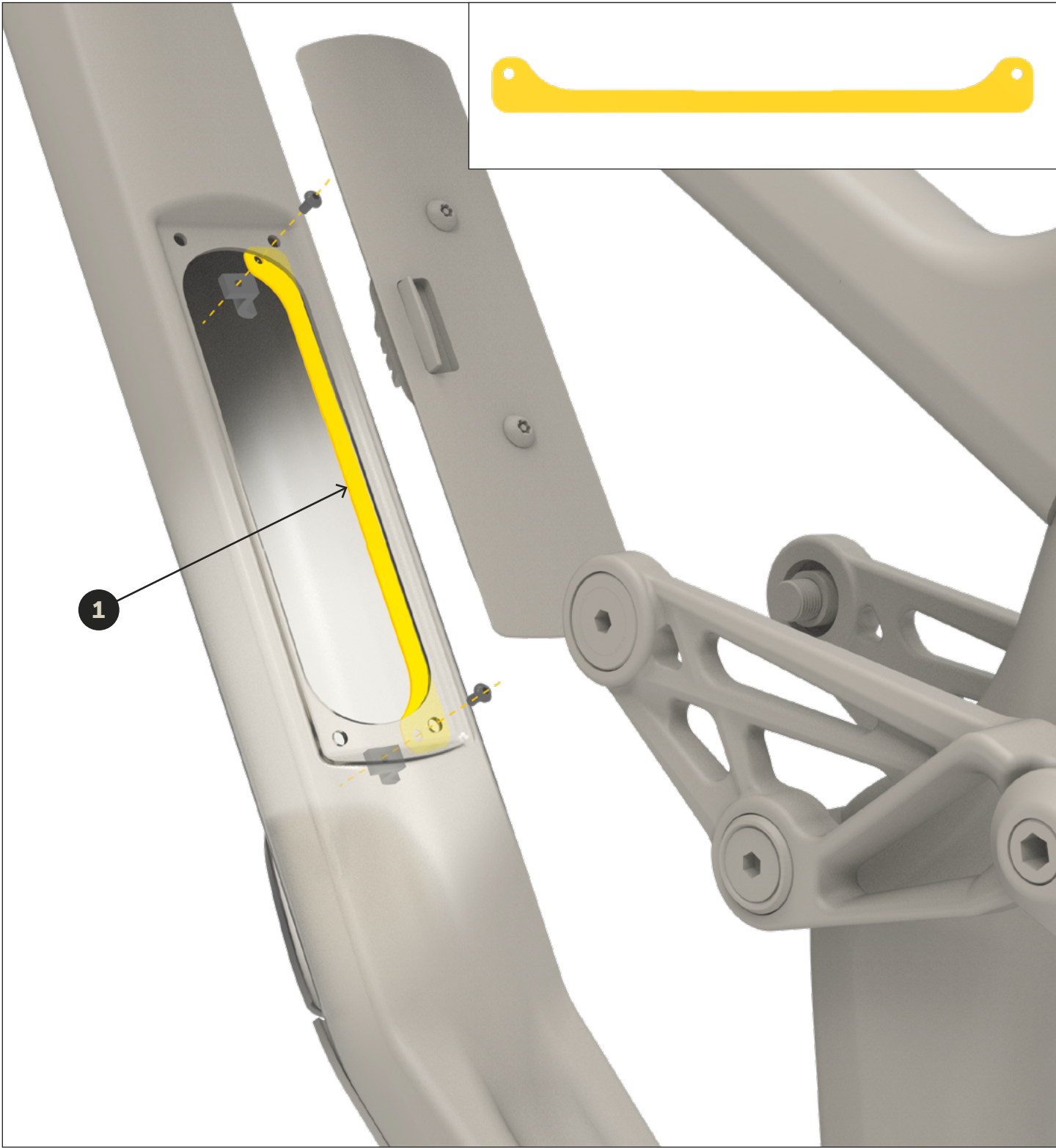

DEVINCI WARRANTY



At Devinci, durability, performance, and peace of mind are at the core of everything we build. That’s why our warranty is designed to protect your investment and support you long after your purchase.

WHAT’S COVERED

FOR THE ORIGINAL OWNER

- **Aluminum frames:** Lifetime warranty* for the bicycle’s useful life
- **Carbon fiber frames:** Lifetime warranty* for the bicycle’s useful life
- **Paint and decals:** 1-year warranty
- **Suspension pivots (bearings, bolts, axles):** 1-year warranty

*Proof of purchase is required for all warranty claims.

COMPONENTS

All components on Devinci bikes are covered by their respective manufacturer warranties. For questions, your authorized Devinci retailer is your go-to resource. <https://www.devinci.com/en/find-a-dealer/>

OUTSIDE THE WARRANTY? WE’VE GOT YOUR BACK.

CUSTOMER ASSISTANCE PROGRAM

Accidents happen. That’s why we created the [Devinci Customer Assistance Program](#).

If your situation isn’t covered under warranty—whether it’s a crash, damage, or just bad luck—we’ll help you get back on the road or trail with a **discount on replacement parts**, based on their original retail price. This program is offered **for life**, at our discretion, and is available through our customer service team or any authorized Devinci retailer.

WHAT’S NOT COVERED

Our warranty does not apply in the following cases:

- Bike not purchased from an authorized Devinci retailer
- Improper assembly or service not performed by an authorized retailer
- Accidents, misuse, or excessive/abusive riding
- Damage from high-intensity use (racing, bike parks, improper transport, etc.)
- Structural or cosmetic modifications to the frame
- Normal wear and tear or material fatigue over time
- Costs of replacing parts that are worn out or obsolete at the time of the claim

For any questions, please contact our customer service team or your nearest Devinci retailer.

DEVINCI WARRANTY POLICY

All Devinci frames are covered by a manufacturer’s warranty against defects in materials and workmanship for a specified period, as detailed below, starting from the date of purchase. Any parts replaced or repaired under this warranty are covered for the remaining duration of the original warranty period.

The bicycle owner must provide proof of purchase to make a warranty claim.

Replacement parts are subject to availability within Devinci’s inventory at the time of the claim. In some cases, the color, features, and/or model may differ from the original part.

At Devinci’s discretion, certain costs may apply when processing a warranty replacement or repair, including:

- Shipping fees
- Additional labor costs associated with the installation or repair of a part
- Costs of replacing parts that are worn out or obsolete at the time of the claim

WARRANTY DURATION

For the original purchaser:

- Aluminum frames are covered for the lifetime of the bicycle’s useful life.
- Carbon fiber frames are covered for the lifetime of the bicycle’s useful life.
- Paint and decals are covered for one (1) year from the original date of purchase.
- Suspension frame pivots (including bearings, bolts, and axles) are covered for one (1) year from the original date of purchase.
- The components assembled on Devinci bicycles are exclusively covered by the warranties provided by their respective manufacturers, with Devinci assuming no responsibility. Please contact your authorized Devinci dealer for more details on applicable warranties.

CUSTOMER ASSISTANCE PROGRAM

For those unexpected moments when your situation is not covered under our warranty policy, Devinci’s Customer Assistance Program is here to help. Whether it’s a crash, accidental damage, or simple bad luck, this program is designed to get you back on the road or trails as quickly as possible by offering a discount on replacement parts based on their original retail price.

This program is separate from Devinci’s manufacturer warranty and is managed at Devinci’s sole discretion. It is accessible through our customer service department or any authorized Devinci retailer.

WARRANTY EXCLUSIONS

At Devinci’s discretion, the warranty may be void under the following circumstances:

- The bicycle was not purchased from an authorized Devinci retailer.
- The bicycle was not fully assembled by an authorized Devinci retailer.
- Repairs were not performed by an authorized Devinci retailer.
- The instructions in the user manual and/or technical manual were not followed.
- Recommended periodic inspections and maintenance outlined in the user manual and/or technical manual were not performed.
- Non-compatible parts were installed. Compatible parts include original components or those specified as compatible in the user manual and/or technical manual.
- Paint damage caused by the application or removal of an adhesive frame protector.

DEVINCI WARRANTY

- Damage resulted from accidental or unforeseen events, such as:
 - Accidents, impacts, or falls
 - Misuse, abnormal or excessive use, or negligence
 - Intensive use beyond the scope of normal recreational cycling
 - Improper or repeated use of ski lifts, vehicle racks, or other transportation methods
 - Use in competition or in environments/activities beyond the intended design of the bicycle
- Additional damage caused by continued use of the bicycle after an initial defect, if a warranty claim was not filed or was denied.
- The frame and/or components were altered (e.g., polishing, structural or mechanical modifications, stripping, sanding, shot peening, etc.).
- The frame size or model is inappropriate for the rider.
- Damage caused by normal wear and tear, including material fatigue over time.

LIMITATION OF LIABILITY

This warranty represents the complete and final warranty coverage for Devinci frames. Devinci does not authorize any individual, including authorized dealers, to offer any additional warranty beyond what is explicitly stated herein. Any other obligations, representations, or illustrations made by any party are not binding on Devinci and are excluded from this warranty.

Subject to applicable laws in Quebec and Canada, Devinci assumes no liability for material, bodily, or moral damages suffered by the user, purchaser, or any other party due to the use of a Devinci frame or component, except in cases of negligence or intentional misconduct by Devinci, as determined by a competent court.

Unless otherwise prohibited by applicable law, Devinci disclaims all other warranties, express or implied, including but not limited to implied warranties of merchantability or fitness for a particular purpose. Devinci's liability will not exceed the actual purchase price of the bicycle, nor will it cover any special, incidental, or consequential damages related to the bicycle.

By claiming warranty rights, the purchaser agrees that any legal proceedings shall be conducted in the judicial district of Chicoutimi, Province of Quebec, Canada.



1987



WE MAKE RIDERS

HEAD OFFICE

1555 Main
Chicoutimi (Quebec) Canada
G7K1G8

www.devinci.com