

WE MAKE RIDERS

CHICOUTIMI, QUÉBEC



CARBON
CHECKER



TECHNICAL MANUAL

HATCHET PRO 2025+

DEVINCI



ABOUT OUR MANUALS

Like many sports, cycling involves risk of injury and accidents, so you must be fully aware of these risks. Neither the manufacturer, the retailer, nor the person who sold you the bike, nor the people who maintain the trails are responsible for these risks. As you are solely responsible, it is, therefore, essential that you read and fully understand all the parts contained in this manual.

To enjoy maximum safety and enjoyment right from the get go, it is important that you are familiar with your new bike, its handling and its possibilities. It is your duty to maintain your bike well and reduce the risk of injury. Biking can be a dangerous activity, even under the best conditions. These are risks associated with using a bicycle that cannot be predicted or avoided. These are the sole responsibility of the cyclist.

YOUR AUTHORIZED DEVINCI RETAILER

Your authorized Devinci retailer is at your service to guide your choices of bike and accessories which are best suited to the style of biking you wish to perform. This will help you maintain your equipment in good condition so that you can take full advantage of your investment. The staff at your authorized Devinci retailer have the training, experience and tools to carry out the repairs and provide you with reliable advice.

However, your authorized Devinci retailer cannot make decisions for you, and cannot be held responsible for your lack of knowledge, experience, qualification or common sense. However, it will take the necessary time to explain the operation of a component or to help you choose an accessory that meets your specific needs.

For further information, please see the Devinci's User Manual available on www.Devinci.com or ask your authorized Devinci retailer. He will take the time to answer any questions you may have and will advise you with great pleasure.



TABLE OF CONTENTS

FRAME: TECHNICAL SPECIFICATIONS

4

CABLE ROUTING

8

SERVICE KITS

18

WARRANTY

32



F R A M E

TECHNICAL SPECIFICATIONS



*** DISCLAIMER:** We are testing many different tires to establish a clearance number that cover a wide spectrum of tires with appropriate frame clearance. However, it is impossible for us to test all tires and rim combination available on the market, so be mindful that some combinations may result in slight rubbing if higher than 45mm in actual width.

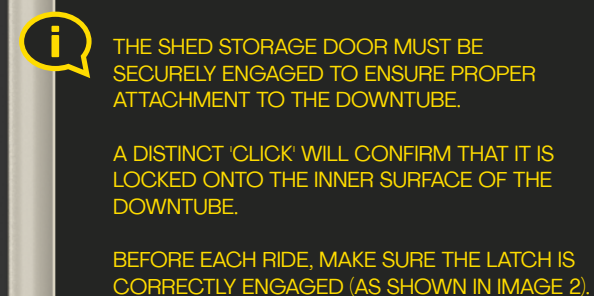

A close-up, low-angle shot of a bicycle handlebar and stem. The handlebar is wrapped in black tape and features a black brake lever on the left. The stem is black with a blue logo. The background is dark and out of focus. The text "CABLE ROUTING" is overlaid in white, bold, sans-serif capital letters.

CABLE ROUTING

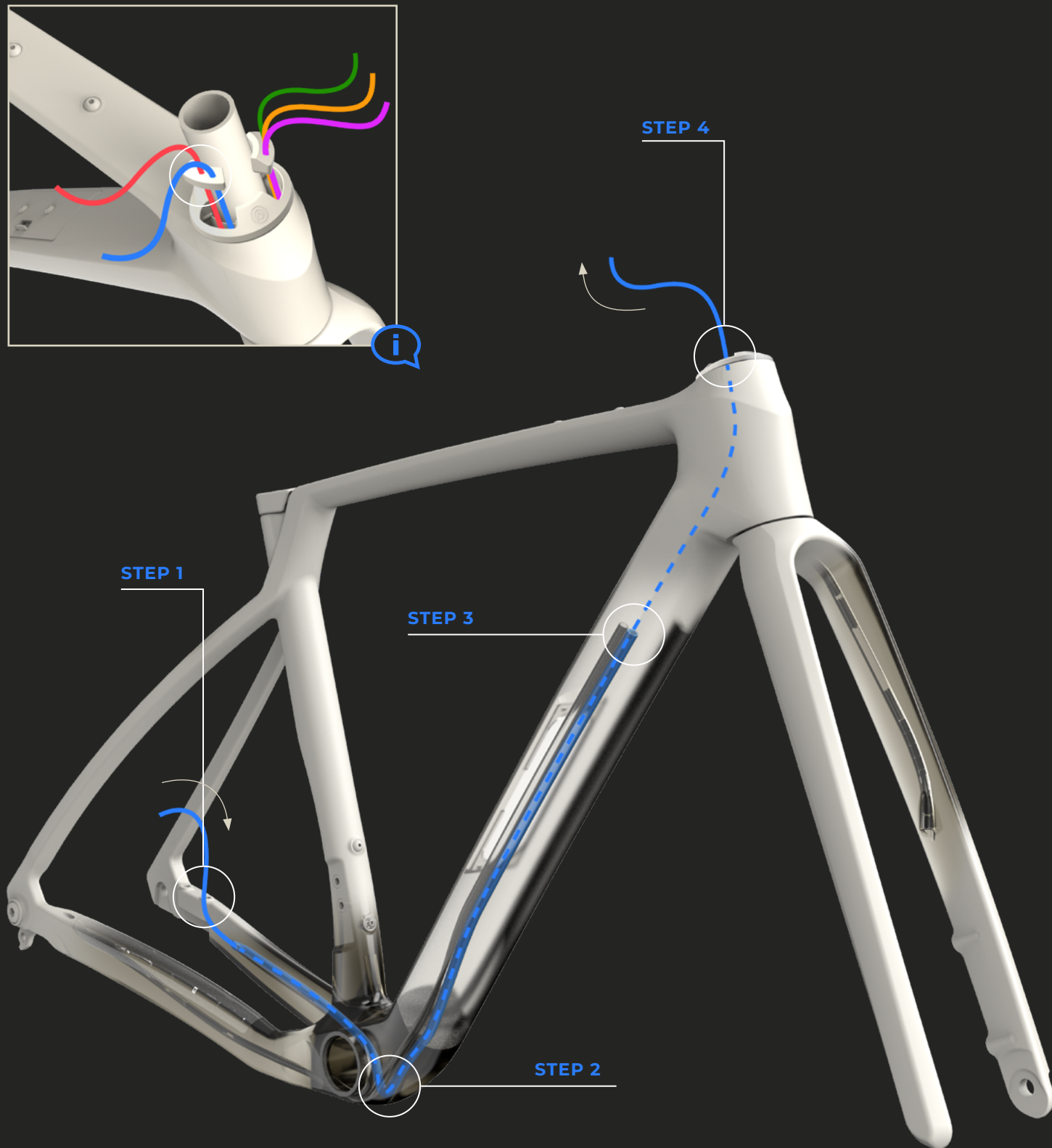

LEGEND

- Rear brake housing
- Housing outside the frame
- - - Housing inside the frame



CABLE ROUTING



REAR BRAKE HOUSING

STEP 1 | Insert the rear brake housing through the guide located on the top of the chainstay, on the left side.

STEP 2 | Route the rear brake housing through the frame using the straw.

STEP 3 | Pull the housing out through the head tube.

STEP 4 | Make sure to route the housing through the right cavity of the headset.

i The rear brake housing must occupy the upper cavity of the rubber guide to be installed on the headset. Make sure the housings remain parallel throughout the process to prevent friction with the fork.

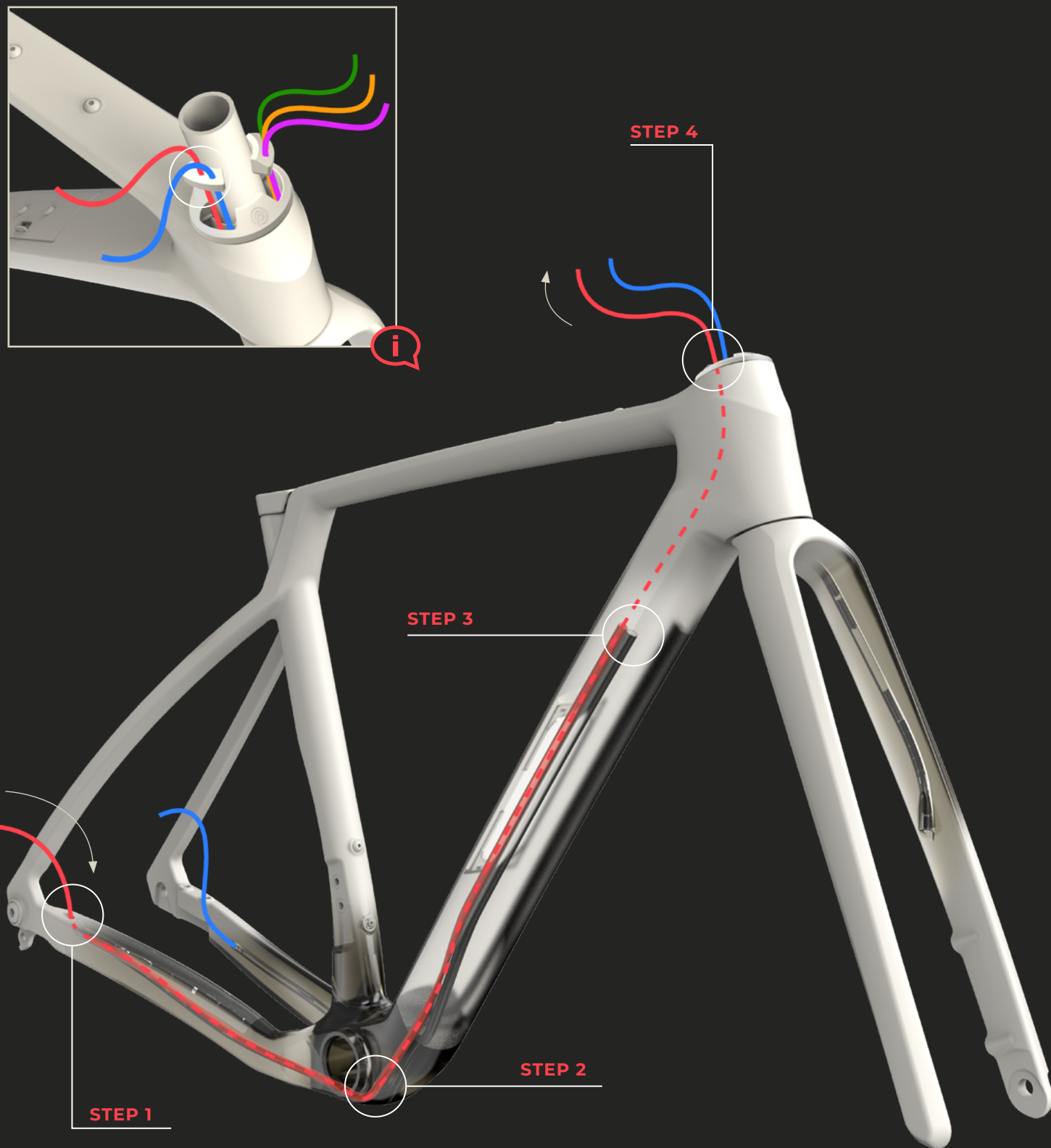

LEGEND

- Rear derailleur housing
- Housing outside the frame
- - - Housing inside the frame

CABLE ROUTING

REAR DERAILLEUR HOUSING

- STEP 1** | Insert the rear derailleur housing through the cavity located on the upper right surface of the chainstay.
- STEP 2** | Route the rear derailleur housing through the frame using the straw.
- STEP 3** | Pull the housing out through the head tube.
- STEP 4** | Make sure to route the housing through the right cavity of the headset.

i The rear derailleur housing must occupy the lower cavity of the rubber guide to be installed on the headset. Ensure the housings remain parallel throughout the process to prevent friction with the fork.

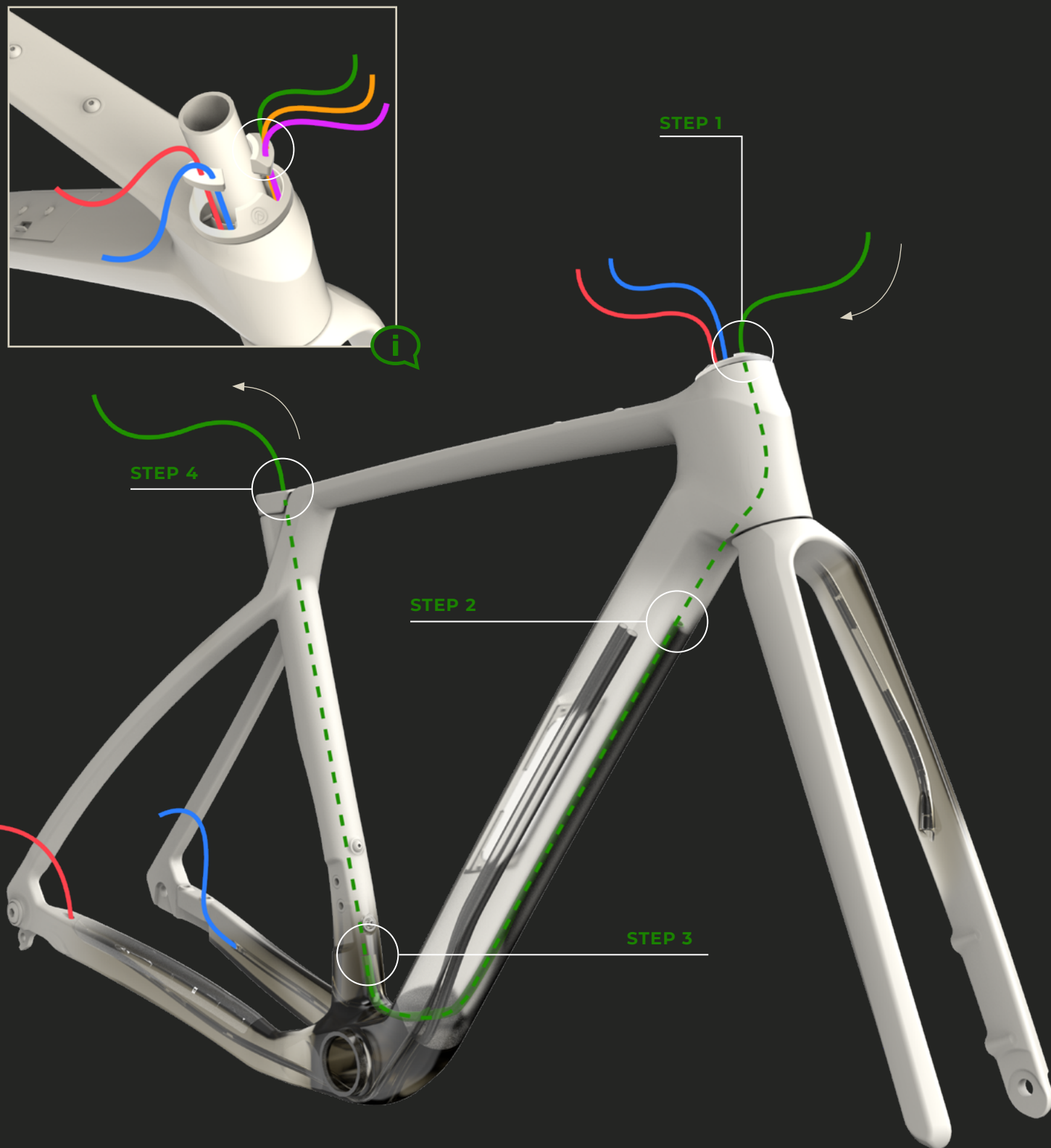

LEGEND

- Seatpost housing
- Housing outside the frame
- Housing inside the frame

CABLE ROUTING



SEATPOST HOUSING

STEP 1 | Insert the seatpost housing into the head tube through the cavity located on the left side.

i The seatpost housing must occupy the lower (smaller) cavity of the left rubber guide to be installed on the headset. Ensure the housings remain parallel throughout the process to prevent friction with the fork.

STEP 2 | Slide the seatpost housing into the upper left straw located in the downtube.

STEP 3 | Gently slide the housing through the straw.

STEP 4 | Pull the housing out of the frame through the seat tube.

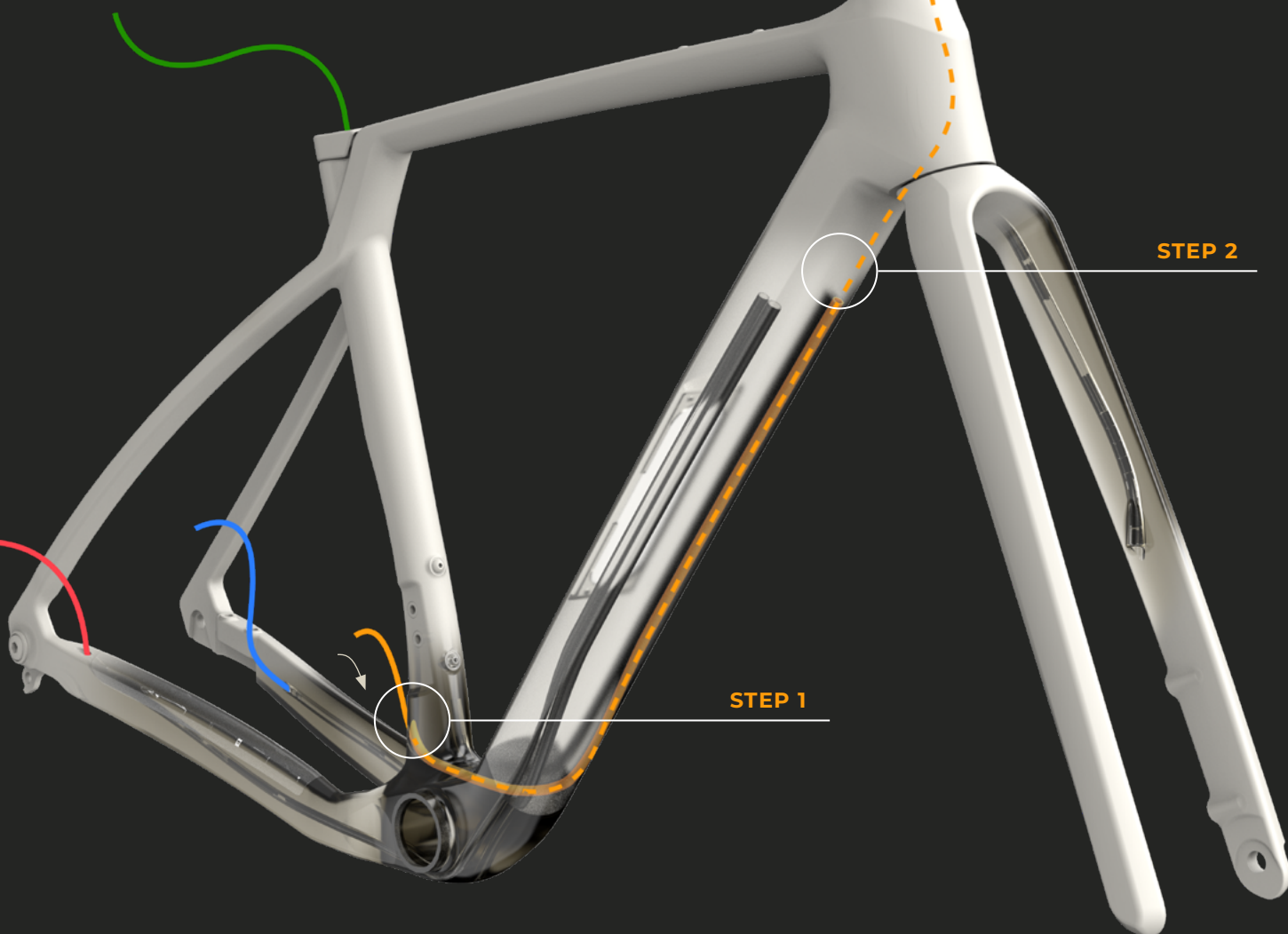
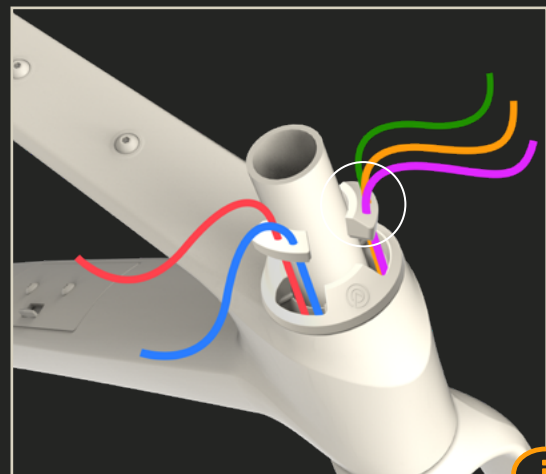

STEP 3

STEP 2

STEP 1

LEGEND

- Seatpost housing
- Housing outside the frame
- Housing inside the frame



CABLE ROUTING



FRONT DERAILLEUR HOUSING

STEP 1 | Insert the front derailleur housing into the downtube through the cavity located at the bottom of the seat tube, just above the bottom bracket.

STEP 2 | Slide the front derailleur housing into the downtube through the designated straw.

STEP 3 | Pull the housing out through the left cavity of the headset.



The front derailleur housing must occupy the central cavity of the left rubber guide to be installed on the headset. Ensure the housings remain parallel throughout the process to prevent friction with the fork.

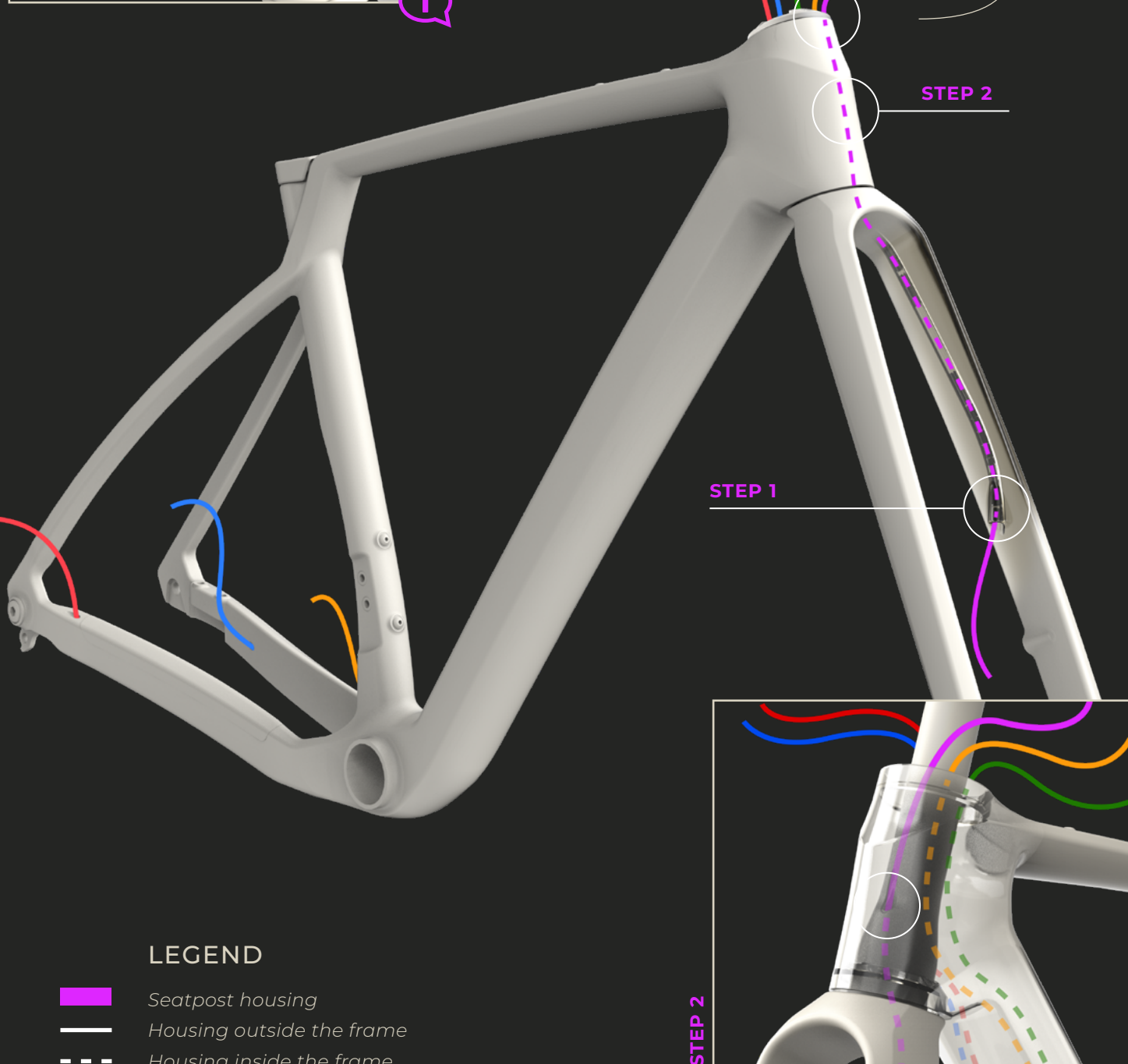
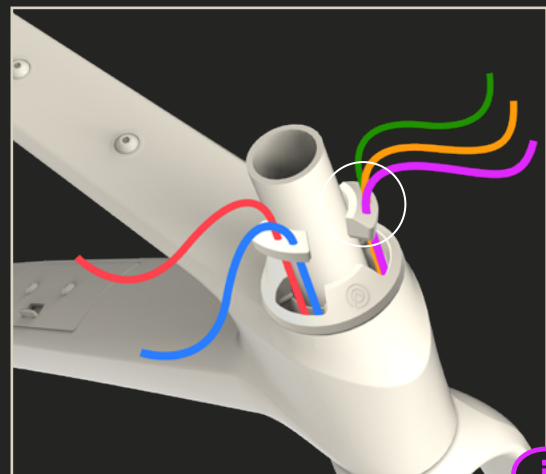

STEP 3

STEP 2

STEP 1

STEP 2

LEGEND

- █ Seatpost housing
- Housing outside the frame
- Housing inside the frame



CABLE ROUTING



FRONT BRAKE HOUSING

STEP 1 | Insert the housing through the left cavity at the bottom of the fork.

STEP 2 | Insert the front brake housing into the fork through the straw.

STEP 3 | Pull the front brake housing out through the left cavity of the headset.



The front brake housing must occupy the upper cavity of the left rubber guide to be installed on the headset. Ensure the housings remain parallel throughout the process to prevent friction with the fork.



CABLE ROUTING OVERVIEW

LEGEND

- Rear brake housing
- Rear derailleur housing
- Seatpost housing
- Front brake housing
- Front derailleur housing
- Routing outside the frame
- - - Routing inside the frame

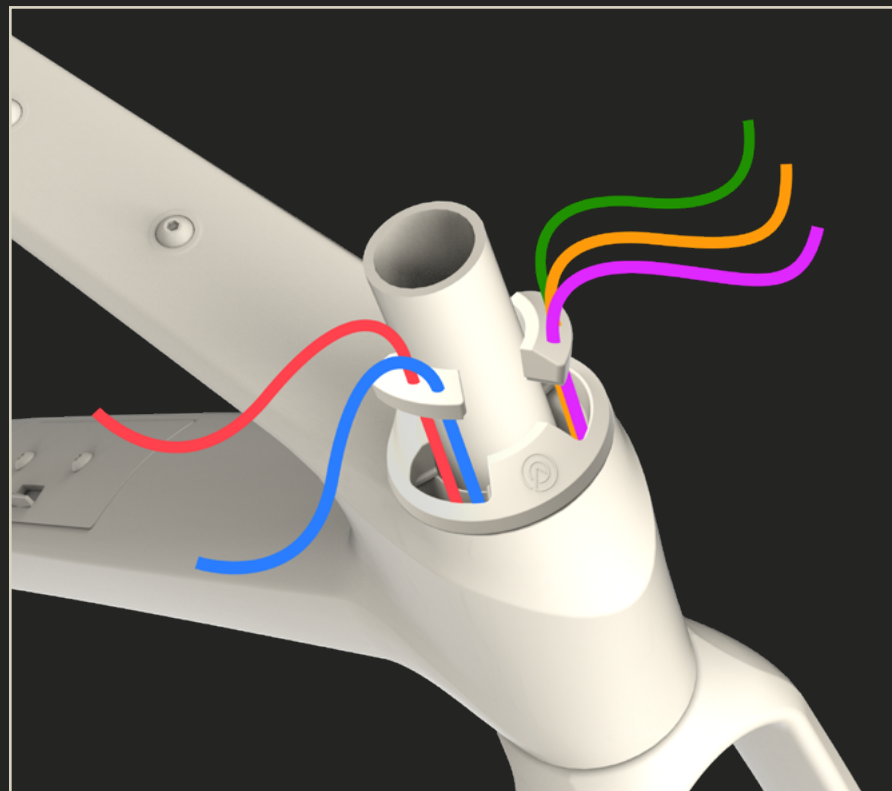

A dark blue Trek bicycle frame is shown, featuring two water bottles attached to the frame. The bottle on the left is labeled '1987' and the one on the right is labeled 'V. devinci'. The text 'SERVICE KITS' is overlaid in white on the right side of the frame. The background is dark and moody.

SERVICE KITS

KFC07801 | HEADSET

ITEMS	PART #	DESCRIPTION	QTY
1	MAAH24003	Head set Accros AIF-557	1

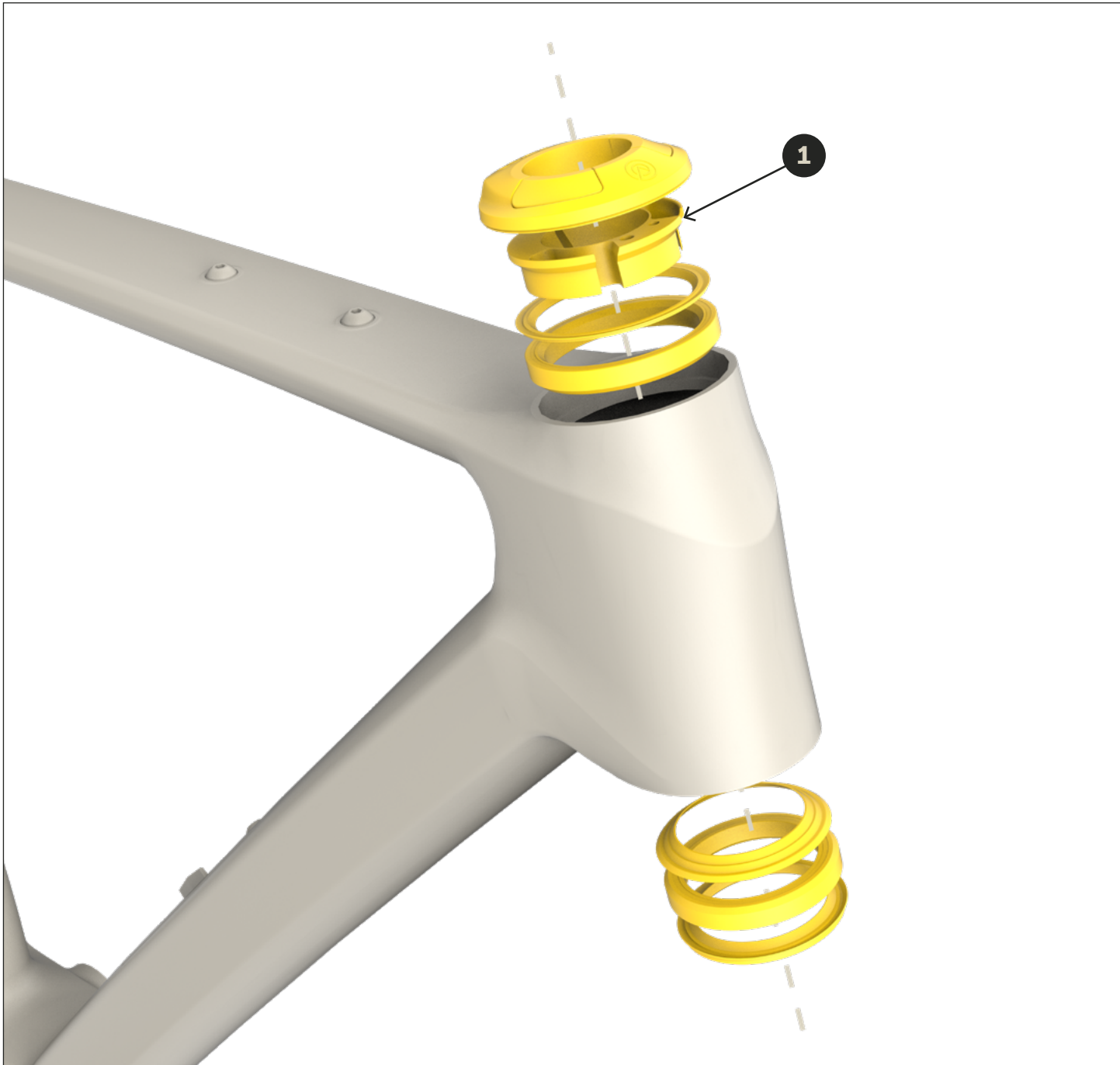

KFC07802 | SEATCLAMP

ITEMS	PART #	DESCRIPTION	QTY
1	MASC24001	Seat Clamp	1

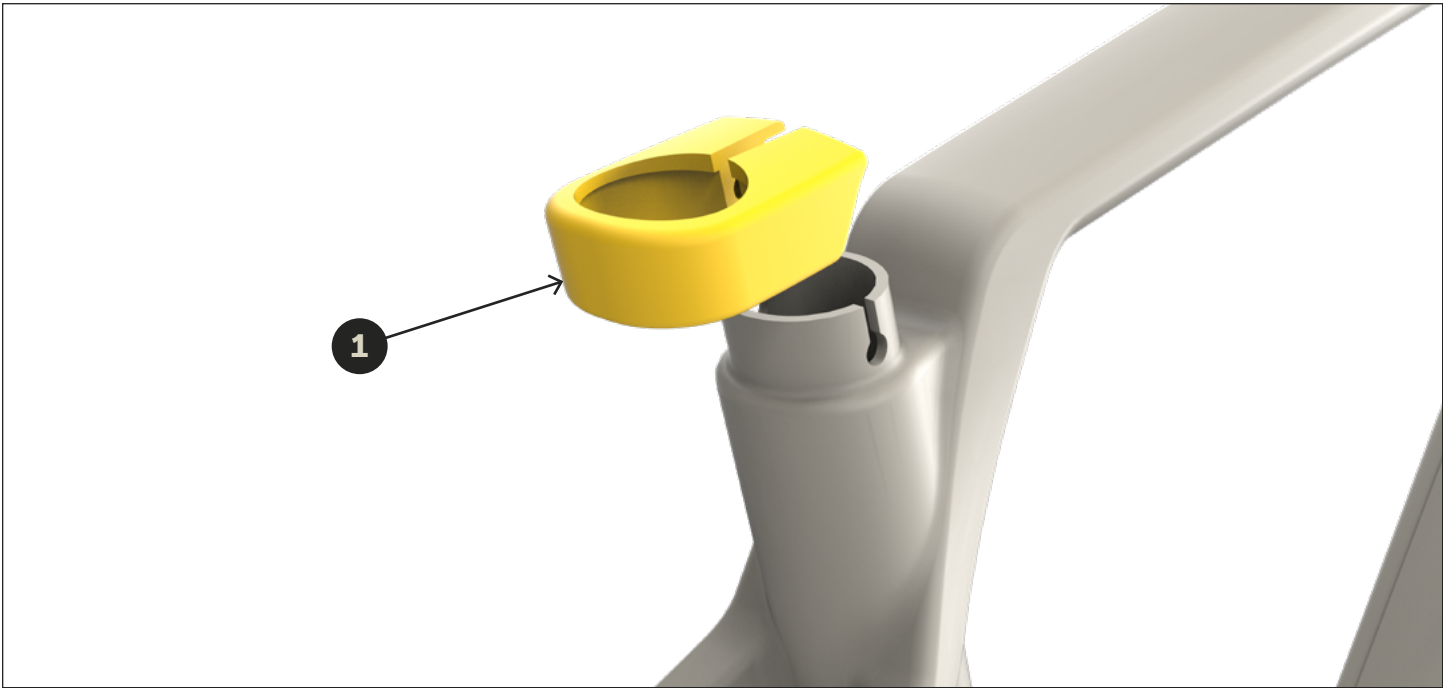

SERVICE PART - ROBERT AXLE PROJECT AVAILABLE AT [ROBERTAXLEPROJECT.COM](https://robertaxleproject.com)

IDENTIFICATION	SPECIFICATIONS
<p>12MM THRU AXLE FOR TRAINER</p> 	<p>160 to 172mm with 1.0 Thread</p> <p>The true length of the axle shaft is 172 mm, but can be shortened using the included spacers – a flat spacer and a tapered X-12 spacer. This allows for axle lengths of 162, 167 or 172 mm. Please note: Thru-axle lengths do not equal hub standards. An axle has to be longer than the hub to fit in the frame. A 12×142 hub does not equal a 142 mm long axle.</p> <p>SKU: TRA213</p>
<p>12MM THRU AXLE FOR KID TRAILER</p> 	<p>The true length of the axle shaft is 172 mm, but can be shortened using the included spacers – a flat 5 mm spacer and a tapered 5 mm X-12 spacer. This allows for axle lengths of 162, 167, or 172 mm. Please note: Thru-axle lengths do not equal hub standards. An axle has to be longer than the hub to fit in the frame. A 12×142(+) hub does not equal a 142mm long axle.</p> <p>SKU: KID213</p>



KFC07803 | PROTECTORS

ITEMS	PART #	DESCRIPTION	QTY
1	MACP24006	FD Hanger Cover Open Road	1
2	MACP24007	CS Protecteur Vinyl Clear	1

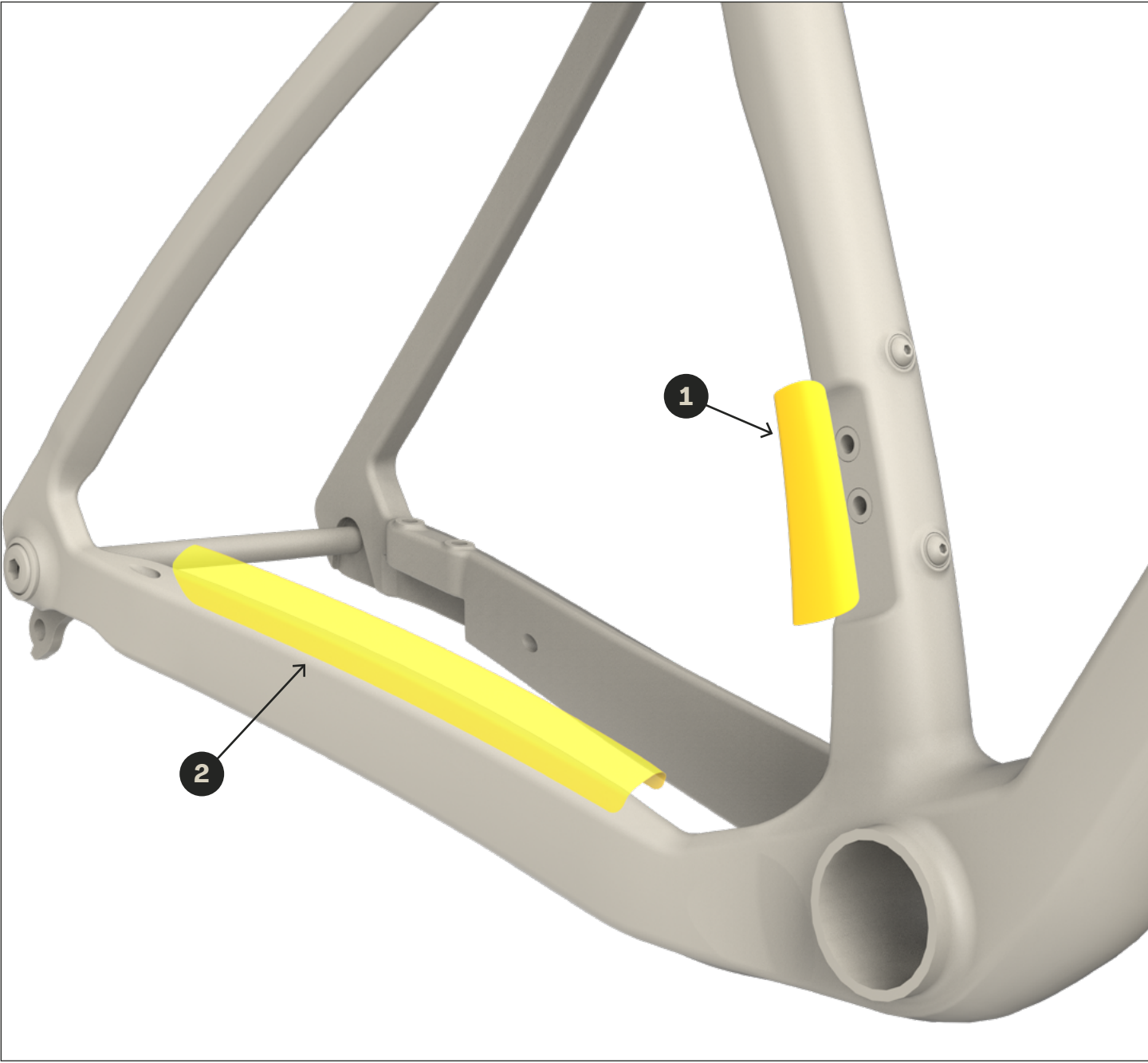

KFC07804 | AXLES

ITEMS	PART #	DESCRIPTION	QTY
1	MAAX24001	Front Thru Axle M12x1.0x100mm (118.5)	1
2	MAAX24003	Rear Thru Axle M12x1.0x165.5mm UDH	1





KFC07805 | FRONT DERAILLEUR HANGER

ITEMS	PART #	DESCRIPTION	QTY
1	MFD21005	FD Hanger Open Road	1

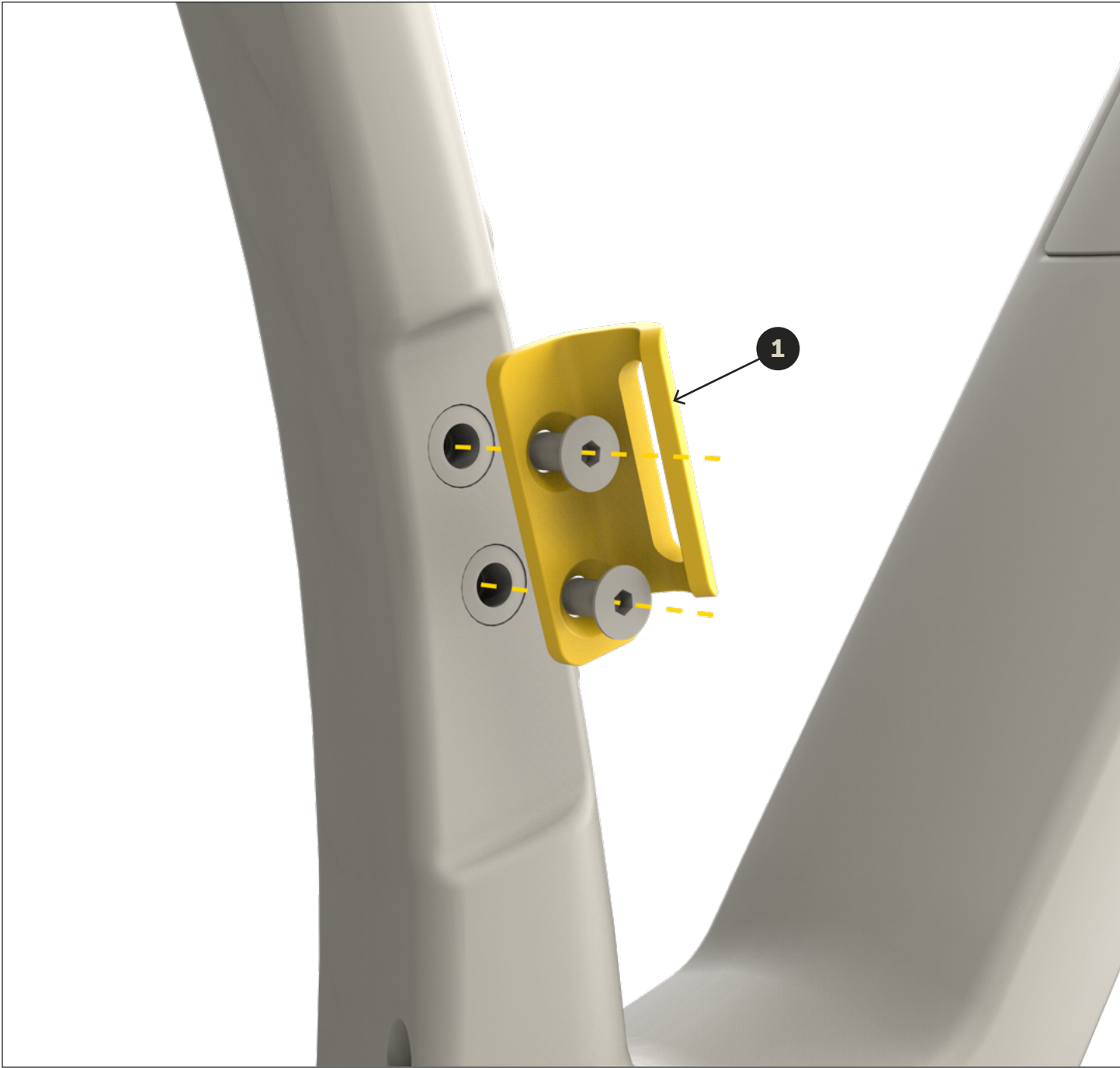

KFC07806 | UNIVERSAL DERAILLEUR HANGER

ITEMS	PART #	DESCRIPTION	QTY
1	MFD23003	UDH Hanger w/25mm washer	1

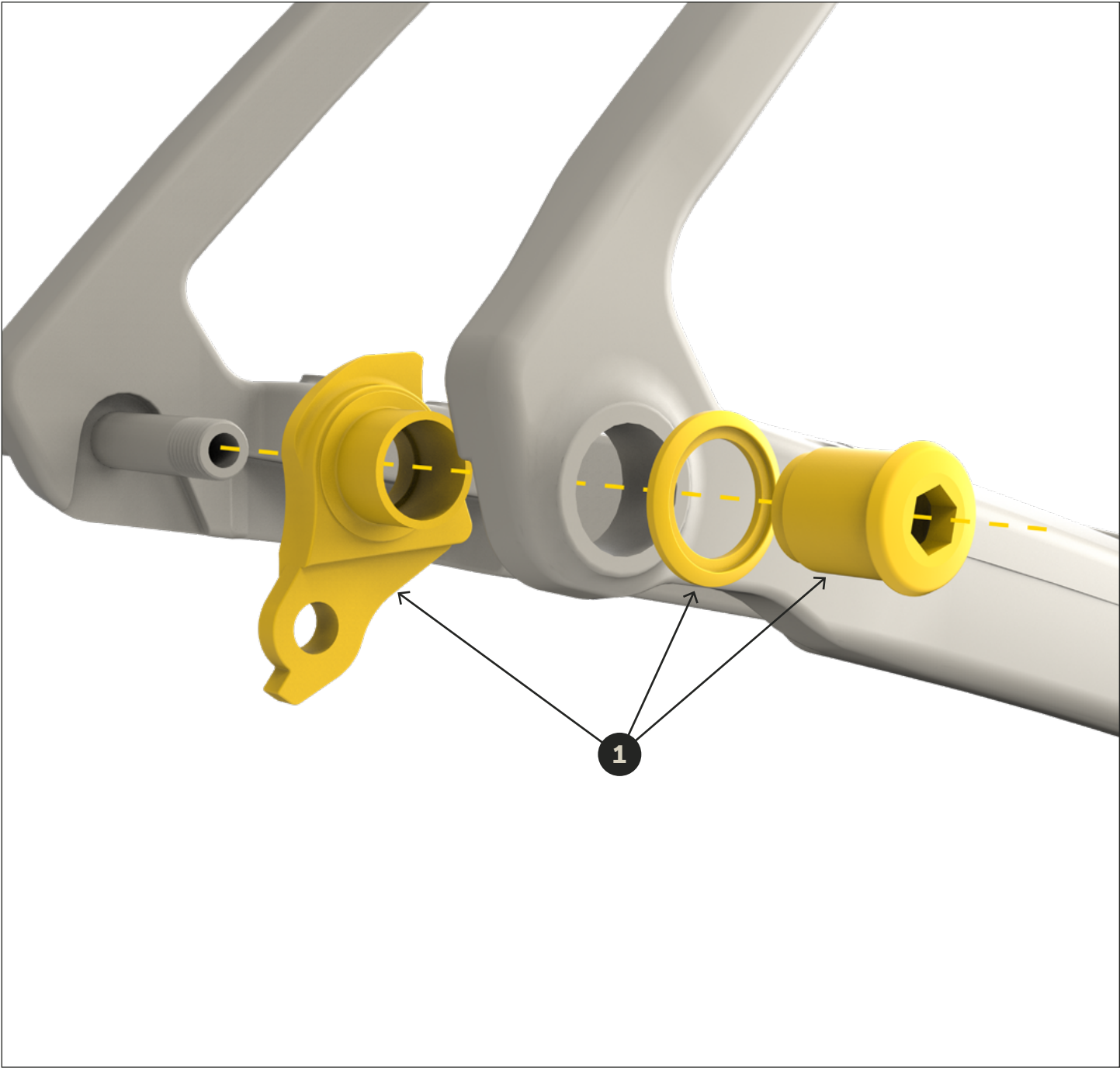

KFC09006 | 'SHED' STORAGE ASSEMBLY

ITEMS	PART #	DESCRIPTION	QTY
1	MPAC24001	PORTE DE RANGEMENT ASSEMBLÉE	1
1.1	MFP24027	SYSTEM DOOR	1
1.2	MFP24028	MECANISM COVER	1
1.3	MFP24029	SYSTEM LOCK	1
1.4	MFV097132	FLAT HEAD THREAD FORMING SCREW FOR PLASTIC, #4 X 3/8"	2
1.5	MFV07003-01	ALLEN BUTTON SCREW M5x0.8 X 12	2
1.6	MFP24030	SYSTEM SEAL	1

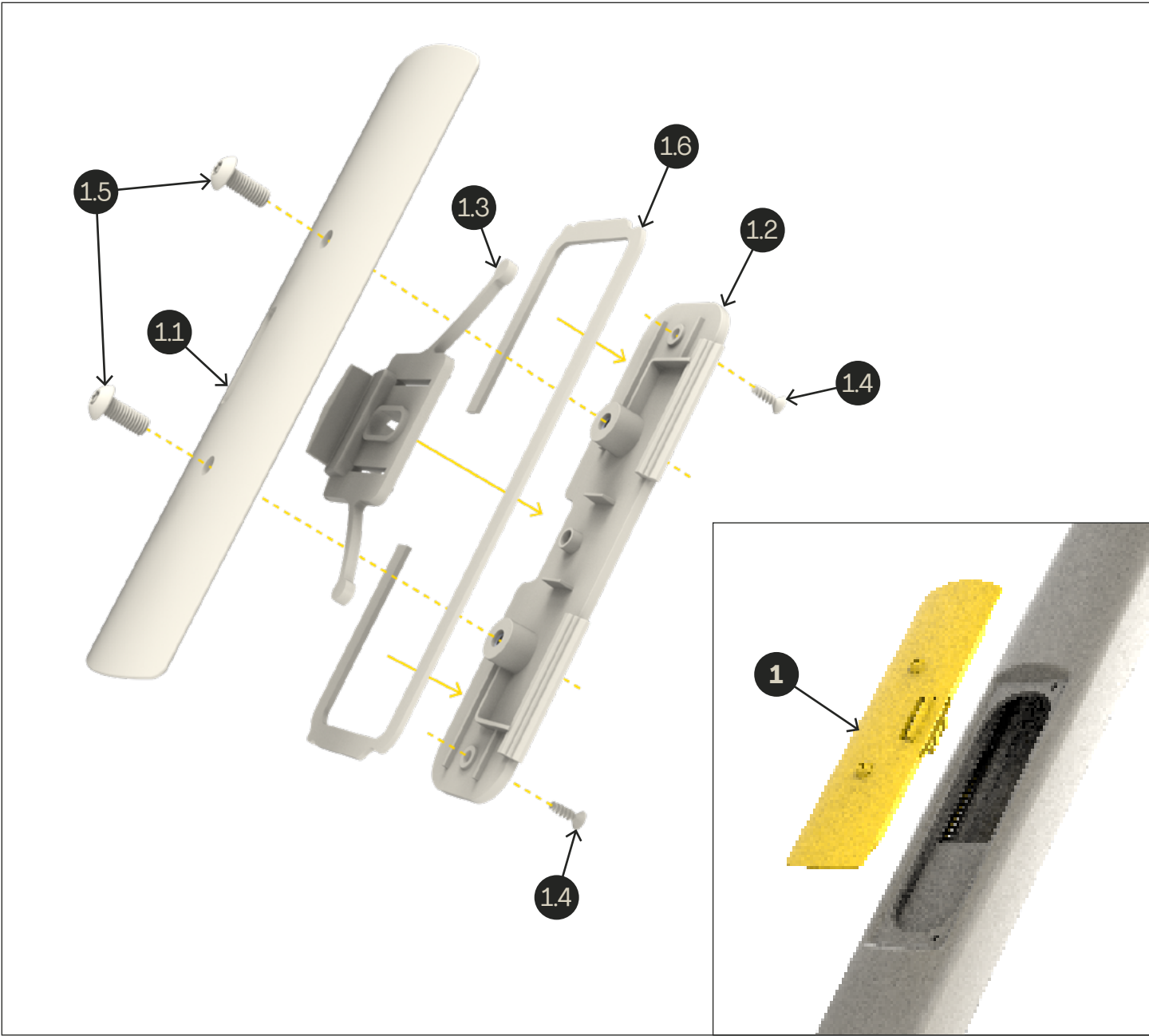

KFC09007 | TOOL BAG FOR SHED STORAGE



ITEMS	PART #	DESCRIPTION	QTY
1	MFP24031	Tool bag	1

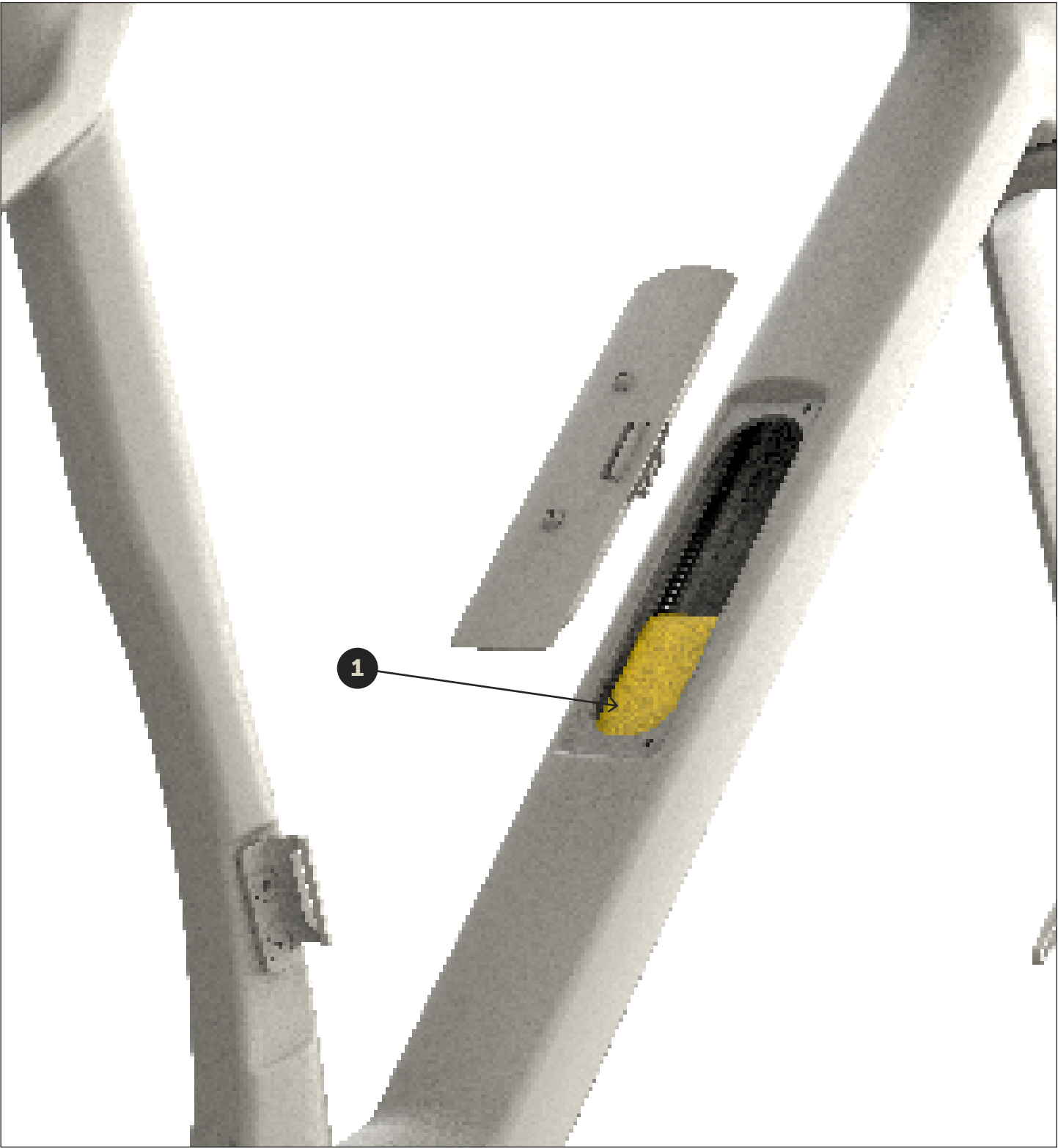

A high-angle, low-perspective shot of a person riding a bicycle on a paved road. The bicycle is dark-colored, and the rider is wearing white socks and dark shoes. The road surface is light-colored and shows some texture. A long, dark shadow of the bicycle and rider is cast onto the road, indicating low sun. The word 'WARRANTY' is overlaid in white, bold, capital letters across the middle of the image.

WARRANTY

DEVINCI WARRANTY



At Devinci, durability, performance, and peace of mind are at the core of everything we build. That’s why our warranty is designed to protect your investment and support you long after your purchase.

WHAT’S COVERED

FOR THE ORIGINAL OWNER

- **Aluminum frames:** Lifetime warranty* for the bicycle’s useful life
- **Carbon fiber frames:** Lifetime warranty* for the bicycle’s useful life
- **Paint and decals:** 1-year warranty
- **Suspension pivots (bearings, bolts, axles):** 1-year warranty

*Proof of purchase is required for all warranty claims.

COMPONENTS

All components on Devinci bikes are covered by their respective manufacturer warranties. For questions, your authorized Devinci retailer is your go-to resource. <https://www.devinci.com/en/find-a-dealer/>

OUTSIDE THE WARRANTY? WE’VE GOT YOUR BACK.

CUSTOMER ASSISTANCE PROGRAM

Accidents happen. That’s why we created the [Devinci Customer Assistance Program](#).

If your situation isn’t covered under warranty—whether it’s a crash, damage, or just bad luck—we’ll help you get back on the road or trail with a **discount on replacement parts**, based on their original retail price. This program is offered **for life**, at our discretion, and is available through our customer service team or any authorized Devinci retailer.

WHAT’S NOT COVERED

Our warranty does not apply in the following cases:

- Bike not purchased from an authorized Devinci retailer
- Improper assembly or service not performed by an authorized retailer
- Accidents, misuse, or excessive/abusive riding
- Damage from high-intensity use (racing, bike parks, improper transport, etc.)
- Structural or cosmetic modifications to the frame
- Normal wear and tear or material fatigue over time
- Costs of replacing parts that are worn out or obsolete at the time of the claim

For any questions, please contact our customer service team or your nearest Devinci retailer.

DEVINCI WARRANTY POLICY

All Devinci frames are covered by a manufacturer’s warranty against defects in materials and workmanship for a specified period, as detailed below, starting from the date of purchase. Any parts replaced or repaired under this warranty are covered for the remaining duration of the original warranty period.

The bicycle owner must provide proof of purchase to make a warranty claim.

Replacement parts are subject to availability within Devinci’s inventory at the time of the claim. In some cases, the color, features, and/or model may differ from the original part.

At Devinci’s discretion, certain costs may apply when processing a warranty replacement or repair, including:

- Shipping fees
- Additional labor costs associated with the installation or repair of a part
- Costs of replacing parts that are worn out or obsolete at the time of the claim

WARRANTY DURATION

For the original purchaser:

- Aluminum frames are covered for the lifetime of the bicycle’s useful life.
- Carbon fiber frames are covered for the lifetime of the bicycle’s useful life.
- Paint and decals are covered for one (1) year from the original date of purchase.
- Suspension frame pivots (including bearings, bolts, and axles) are covered for one (1) year from the original date of purchase.
- The components assembled on Devinci bicycles are exclusively covered by the warranties provided by their respective manufacturers, with Devinci assuming no responsibility. Please contact your authorized Devinci dealer for more details on applicable warranties.

CUSTOMER ASSISTANCE PROGRAM

For those unexpected moments when your situation is not covered under our warranty policy, Devinci’s Customer Assistance Program is here to help. Whether it’s a crash, accidental damage, or simple bad luck, this program is designed to get you back on the road or trails as quickly as possible by offering a discount on replacement parts based on their original retail price.

This program is separate from Devinci’s manufacturer warranty and is managed at Devinci’s sole discretion. It is accessible through our customer service department or any authorized Devinci retailer.

WARRANTY EXCLUSIONS

At Devinci’s discretion, the warranty may be void under the following circumstances:

- The bicycle was not purchased from an authorized Devinci retailer.
- The bicycle was not fully assembled by an authorized Devinci retailer.
- Repairs were not performed by an authorized Devinci retailer.
- The instructions in the user manual and/or technical manual were not followed.
- Recommended periodic inspections and maintenance outlined in the user manual and/or technical manual were not performed.
- Non-compatible parts were installed. Compatible parts include original components or those specified as compatible in the user manual and/or technical manual.
- Paint damage caused by the application or removal of an adhesive frame protector.

DEVINCI WARRANTY

- Damage resulted from accidental or unforeseen events, such as:
 - Accidents, impacts, or falls
 - Misuse, abnormal or excessive use, or negligence
 - Intensive use beyond the scope of normal recreational cycling
 - Improper or repeated use of ski lifts, vehicle racks, or other transportation methods
 - Use in competition or in environments/activities beyond the intended design of the bicycle
- Additional damage caused by continued use of the bicycle after an initial defect, if a warranty claim was not filed or was denied.
- The frame and/or components were altered (e.g., polishing, structural or mechanical modifications, stripping, sanding, shot peening, etc.).
- The frame size or model is inappropriate for the rider.
- Damage caused by normal wear and tear, including material fatigue over time.

LIMITATION OF LIABILITY

This warranty represents the complete and final warranty coverage for Devinci frames. Devinci does not authorize any individual, including authorized dealers, to offer any additional warranty beyond what is explicitly stated herein. Any other obligations, representations, or illustrations made by any party are not binding on Devinci and are excluded from this warranty.

Subject to applicable laws in Quebec and Canada, Devinci assumes no liability for material, bodily, or moral damages suffered by the user, purchaser, or any other party due to the use of a Devinci frame or component, except in cases of negligence or intentional misconduct by Devinci, as determined by a competent court.

Unless otherwise prohibited by applicable law, Devinci disclaims all other warranties, express or implied, including but not limited to implied warranties of merchantability or fitness for a particular purpose. Devinci's liability will not exceed the actual purchase price of the bicycle, nor will it cover any special, incidental, or consequential damages related to the bicycle.

By claiming warranty rights, the purchaser agrees that any legal proceedings shall be conducted in the judicial district of Chicoutimi, Province of Quebec, Canada.



1987



WE MAKE RIDERS

HEAD OFFICE

1555 Main
Chicoutimi (Quebec) Canada
G7K1G8

www.devinci.com