

TECHNICAL MANUAL
2025+ TROY CARBON



BUILD GX AXS
COLOR INCOGNITO

WE MAKE RIDERS

DEVINCI



ABOUT OUR MANUALS

Like many sports, cycling involves risk of injury and accidents, so you must be fully aware of these risks. Neither the manufacturer, the retailer, nor the person who sold you the bike, nor the people who maintain the trails are responsible for these risks. As you are solely responsible, it is, therefore, essential that you read and fully understand all the parts contained in this manual.

To enjoy maximum safety and enjoyment right from the get go, it is important that you are familiar with your new bike, its handling and its possibilities. It is your duty to maintain your bike well and reduce the risk of injury. Biking can be a dangerous activity, even under the best conditions. These are risks associated with using a bicycle that cannot be predicted or avoided. These are the sole responsibility of the cyclist.

YOUR AUTHORIZED DEVINCI RETAILER

Your authorized Devinci retailer is at your service to guide your choices of bike and accessories which are best suited to the style of biking you wish to perform. This will help you maintain your equipment in good condition so that you can take full advantage of your investment. The staff at your authorized Devinci retailer have the training, experience and tools to carry out the repairs and provide you with reliable advice.

However, your authorized Devinci retailer cannot make decisions for you, and cannot be held responsible for your lack of knowledge, experience, qualification or common sense. However, it will take the necessary time to explain the operation of a component or to help you choose an accessory that meets your specific needs.

For further information, please see the Devinci's User Manual available on www.Devinci.com or ask your authorized Devinci retailer. He will take the time to answer any questions you may have and will advise you with great pleasure.

TABLE OF CONTENTS

TECHNICAL SPECIFICATIONS	4
GEOMETRY	8
CABLE ROUTING	12
SERVICE KITS	22
WARRANTY	32

TECHNICAL SPECIFICATIONS

FORK TRAVEL ALTERATION



The Devinci Troy carbon is specifically designed and tested for use with a 160 mm travel front suspension fork. Any modifications to the fork travel or style, including but not limited to a 170 mm travel fork, are not recommended and will void the original frame warranty.

The maximum allowable axle-to-crown length for the Devinci Troy carbon is 576 mm. Exceeding this measurement may compromise the bike's performance and safety, potentially leading to catastrophic frame failure and serious personal injury.

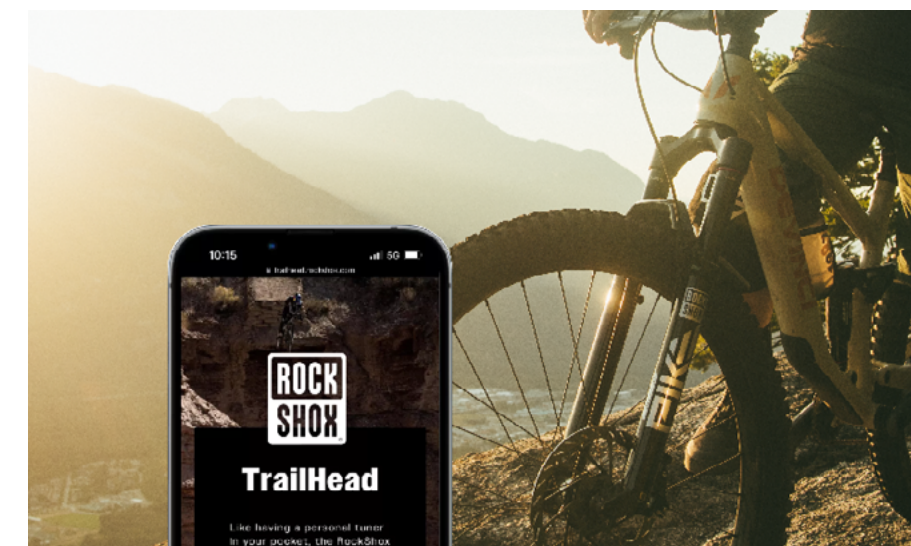

SUSPENSION SET UP

Suspension specialist in your pocket! The RockShox TrailHead app is a starting point for dialing in your suspension settings, ensuring a perfect ride experience.

WEB: [START](#)

APPLE STORE: [DOWNLOAD THE APP](#)

GOOGLE STORE: [DOWNLOAD THE APP](#)

TROY CARBON

FRAME

HEADTUBE DIMENSIONS		
1. UPPER (S.H.I.S)	ZS44	1-1/8" Zerostack
2. LOWER (S.H.I.S)	ZS56	1.5" Zerostack
BOTTOM BRACKET		
3. STANDARD	BSA 73mm	
4. ISCG MOUNT	ISCG 05 3 tabs	
5. MINIMUM Q FACTOR	168	
DRIVETRAIN		
6. REAR HUB SPACING (OVER LOCKNUT DIMENSION)	TA 12x148 Boost	
7. MAX & MIN CHAINRING	34T	28T
8. SMALLEST COG COMPATIBLE	12s 9T	
9. BIGGEST COG COMPATIBLE	12s 52T	
10. RECOMMENDED CHAINLINE	55mm	
SEATPOST AND SEATCLAMP		
11. SEAT TUBE INSIDE DIAMETER (ID)	31.6 mm	
12. SEAT TUBE OUTSIDE DIAMETER (OD)	36 mm	
13. DROPPER POST COMPATIBLE	Yes Fully internal	
BRAKES		
14. BRAKE MOUNT (FRAME)	200 mm direct	
15. MAX ROTOR SIZE AVAILABLE (FRAME))	220 mm	
ACCESSORIES		
16. WATER BOTTLE (FRAME)	Yes (16 oz.)	
17. STORAGE SYSTEM	Yes SHED	
18. PROTECTORS	Downtube, chainstay and seatstay	
GEOMETRY INPUTS (BASED ON MEDIUM SIZE)		
TROY CARBON FORK 160 MM TRAVEL 150MM		
19. FRONT SUSPENSION (TRAVEL & SAG)	160 mm	25%
20. REAR SUSPENSION (TRAVEL & SAG)	150 mm	30%
21. FORK (AXLE-TO-CROWN [A] & OFFSET [B])	A. 571mm	B. 44mm
23. FRONT AND REAR WHEEL MAX ETRTO	63-622	63-622
24. REAR SUSPENSION (DIMENSIONS)	185 x 55 mm	
25. PIGGYBACK SHOCK COMPATIBILITY	Yes	
26. SPRING TYPE COMPATIBILITY	Air & Coil	
28. UPPER SHOCK HARDWARE DIMENSION	Trunnion	
29. LOWER SHOCK HARDWARE DIMENSION	40 x 10 mm	

*** DISCLAIMER**
We are testing many different tires to establish a clearance number that cover a wide spectrum of tires with appropriate frame clearance. However, it is impossible for us to test all tires and rim combination available on the market, so be mindful that some combinations may result in slight rubbing if higher than 68mm in actual width.

SIZES AVAILABLE
S | M | L | XL

13. MAX INSERTION LENGTH
SMALL - 240mm
MEDIUM - 280mm
LARGE - 305mm
X-LARGE - 330mm

1. HEADSET
2. LOWER HEADTUBE
3. CRANKSET
4. PEDAL
5. SEATPOST
6. REAR HUB
7. MAX & MIN CHAINRING
8. SMALLEST COG
9. BIGGEST COG
10. RECOMMENDED CHAINLINE
11. SEAT TUBE INSIDE DIAMETER (ID)
12. SEAT TUBE OUTSIDE DIAMETER (OD)
13. DROPPER POST COMPATIBLE
14. BRAKE MOUNT (FRAME)
15. MAX ROTOR SIZE AVAILABLE (FRAME))
16. WATER BOTTLE (FRAME)
17. STORAGE SYSTEM
18. PROTECTORS
19. FRONT SUSPENSION (TRAVEL & SAG)
20. REAR SUSPENSION (TRAVEL & SAG)
21. FORK (AXLE-TO-CROWN [A] & OFFSET [B])
22. FRONT AND REAR WHEEL MAX ETRTO
23. REAR SUSPENSION (DIMENSIONS)
24. PIGGYBACK SHOCK COMPATIBILITY
25. SPRING TYPE COMPATIBILITY
26. UPPER SHOCK HARDWARE DIMENSION
27. LOWER SHOCK HARDWARE DIMENSION

GEOMETRY



GEOMETRY

TROY CARBON

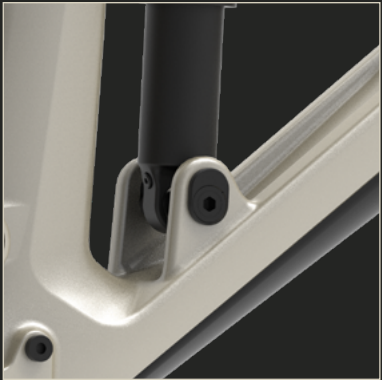
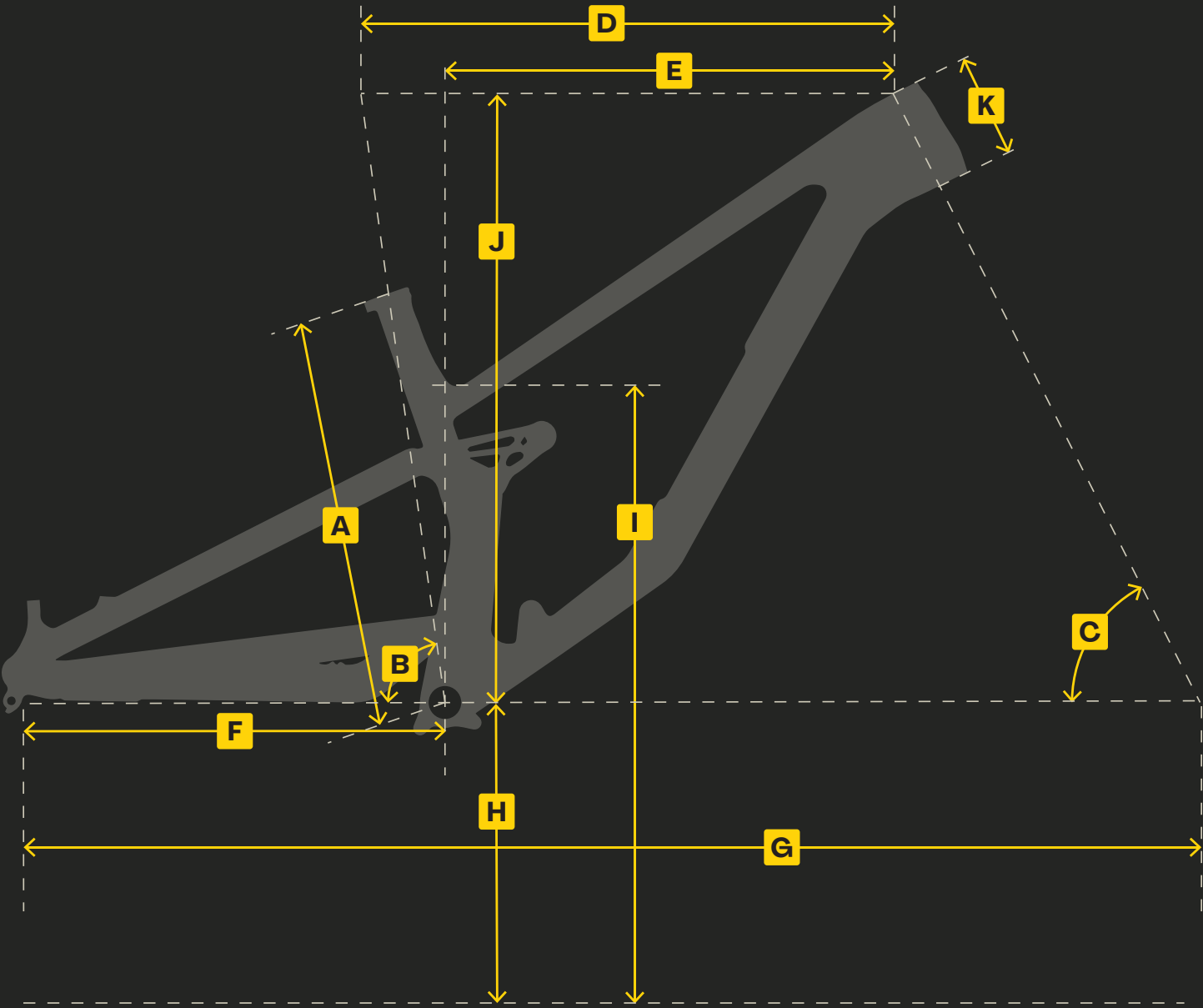

MX

29"

29"

	SMALL 160 CM - 170 CM	MEDIUM 169 CM - 179 CM	LARGE 178 CM - 188 CM	X-LARGE 187 CM - 198 CM
A - ST (MM)	390	420	450	470
B - SA (DEG)	78.1	77.8	76.8	76.2
C - HA (DEG)	64.0	64.0	64.0	64.0
D - TT (MM)	568	594	631	656
E - REACH (MM)	440	460	480	500
F - CS (MM)	432	432	437	442
G - WB (MM)	1204	1228	1258	1287
H - BBH (MM)	343	343	343	343
I - SOH (MM)	708	708	708	708
J - STACK (MM)	612	622	631	640
K - HT (MM)	95	105	115	125

A - ST (MM)	390	420	450	470
B - SA (DEG)	78.1	77.8	76.4	76.2
C - HA (DEG)	64.0	64.0	64.0	64.0
D - TT (MM)	568	594	631	656
E - REACH (MM)	440	460	480	500
F - CS (MM)	435	435	440	445
G - WB (MM)	1206	1230	1260	1289
H - BBH (MM)	343	343	343	343
I - SOH (MM)	708	708	708	708
J - STACK (MM)	612	622	631	640
K - HT (MM)	95	105	115	125

A - ST (MM)	390	420	450	470
B - SA (DEG)	78.9	78.6	77.6	77.0
C - HA (DEG)	64.7	64.7	64.7	64.7
D - TT (MM)	567	593	630	655
E - REACH (MM)	449	469	488	508
F - CS (MM)	432	432	437	442
G - WB (MM)	1204	1228	1258	1287
H - BBH (MM)	354	354	354	354
I - SOH (MM)	718	718	718	718
J - STACK (MM)	606	615	624	633
K - HT (MM)	95	105	115	125

A close-up photograph of a bicycle's headset area. The focus is on a teal-colored fork with a matte finish. A black cable is being routed through a small hole in the fork. The background is blurred, showing parts of the bicycle frame and handlebars. The text "CABLE ROUTING" is overlaid in white, bold, sans-serif font on the left side of the image.

CABLE ROUTING

SEAT POST HOUSING

TROY CARBON

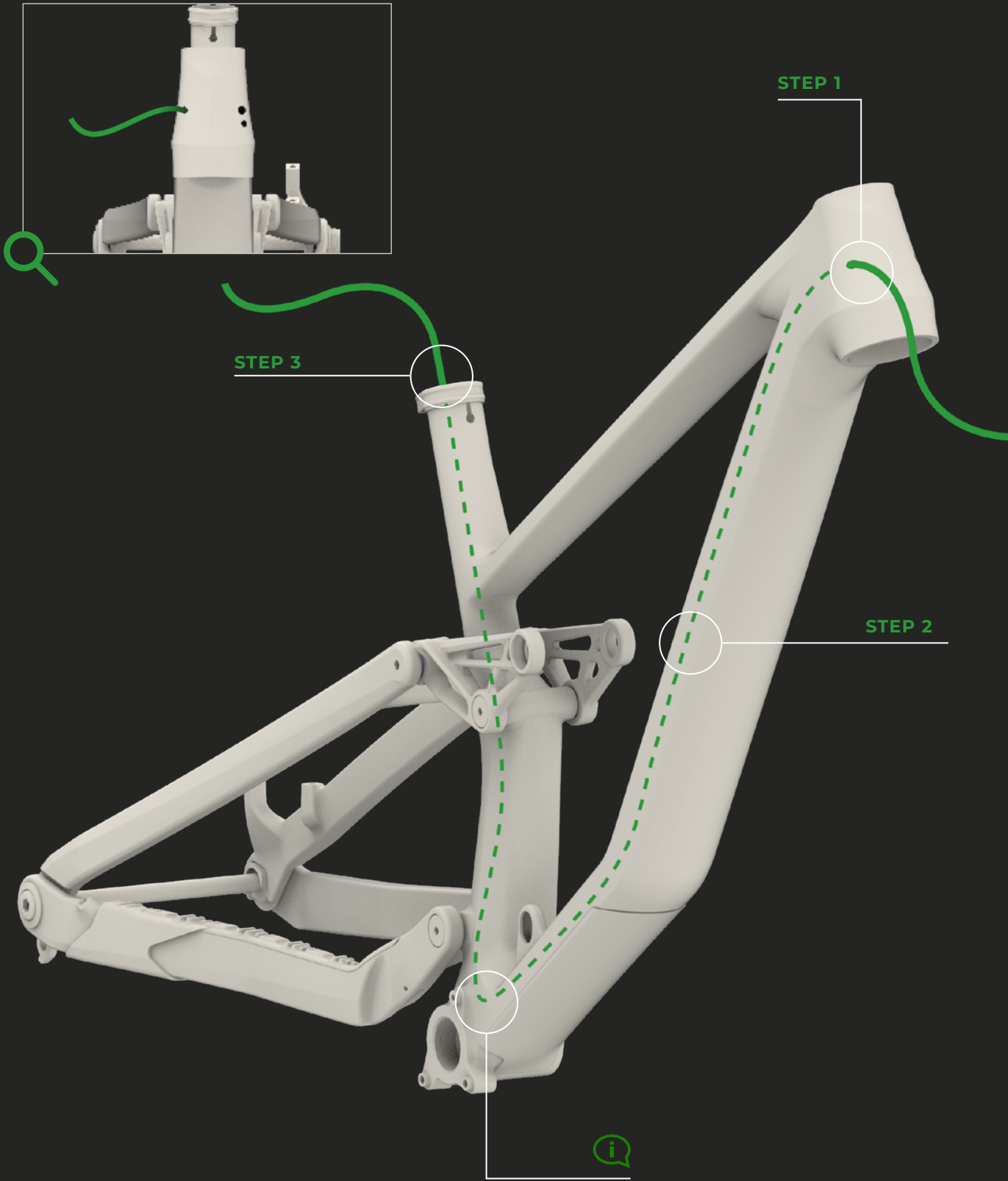

STEP 1

Insert the seatpost housing into the upper right internal conduit located in the diagonal tube.

STEP 2

Gently slide the housing through the internal conduit.

STEP 3

Pull the housing out of the frame through the seat tube.



If you encounter difficulty inserting the housing into the internal conduit for the seatpost, thread a cable through the housing to help guide it, applying light tension to the cable until it exits through the seat tube.

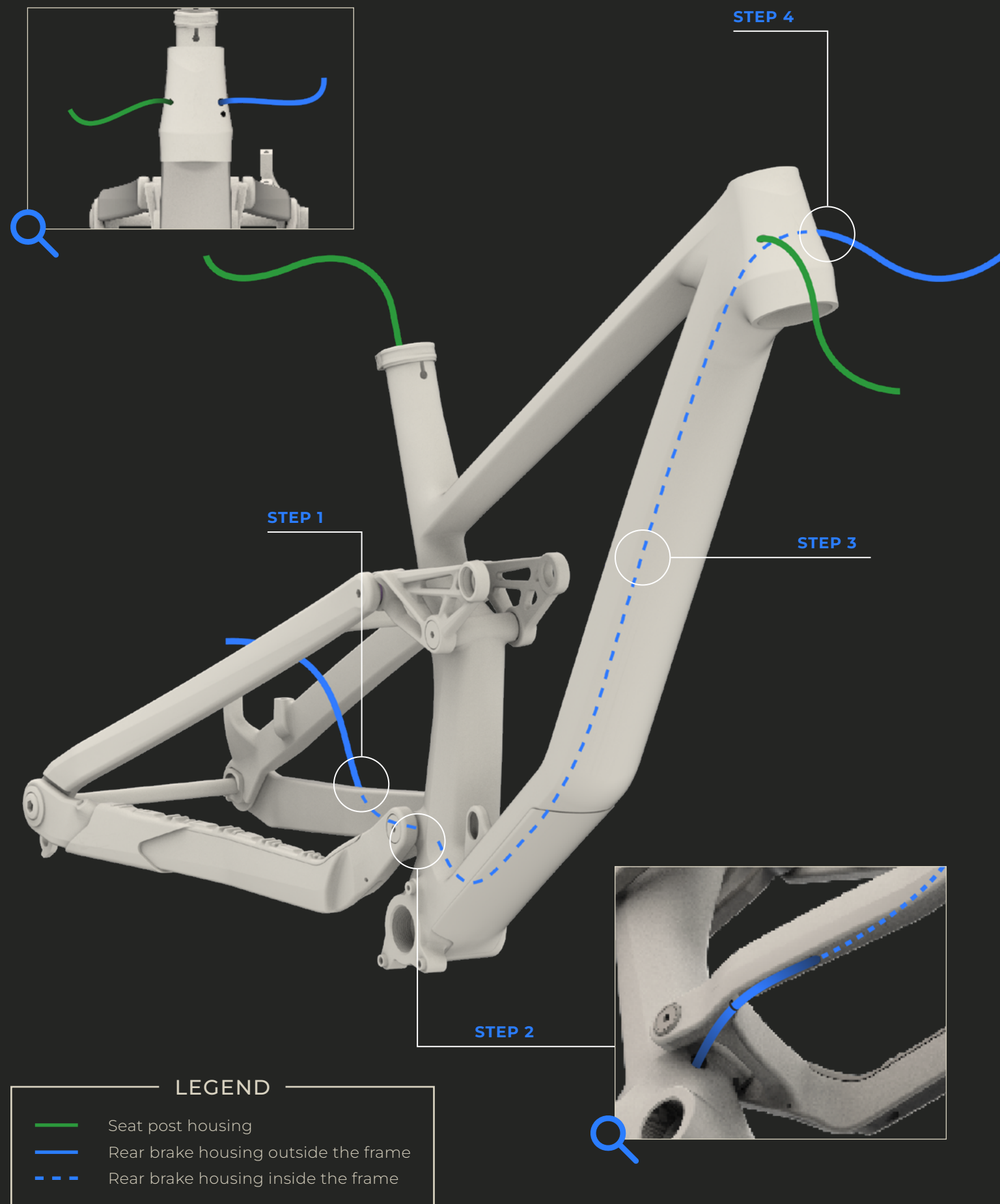

REAR BRAKE HOUSING

TROY CARBON

STEP 1

Insert the rear brake housing into the upper left cavity located on top of the chainstay.

STEP 2

Pull the brake housing out from under the chainstay on the left. Insert the housing into the internal conduit located at the rear left of the seatpost tube.

STEP 3

Gently slide the housing through the internal conduit.

STEP 4

Pull the brake housing out of the upper left cavity of the diagonal tube.



Make sure the housing is inside the chainsaty before connecting the housing to the brake.

REAR DERAILLEUR HOUSING

TROY CARBON

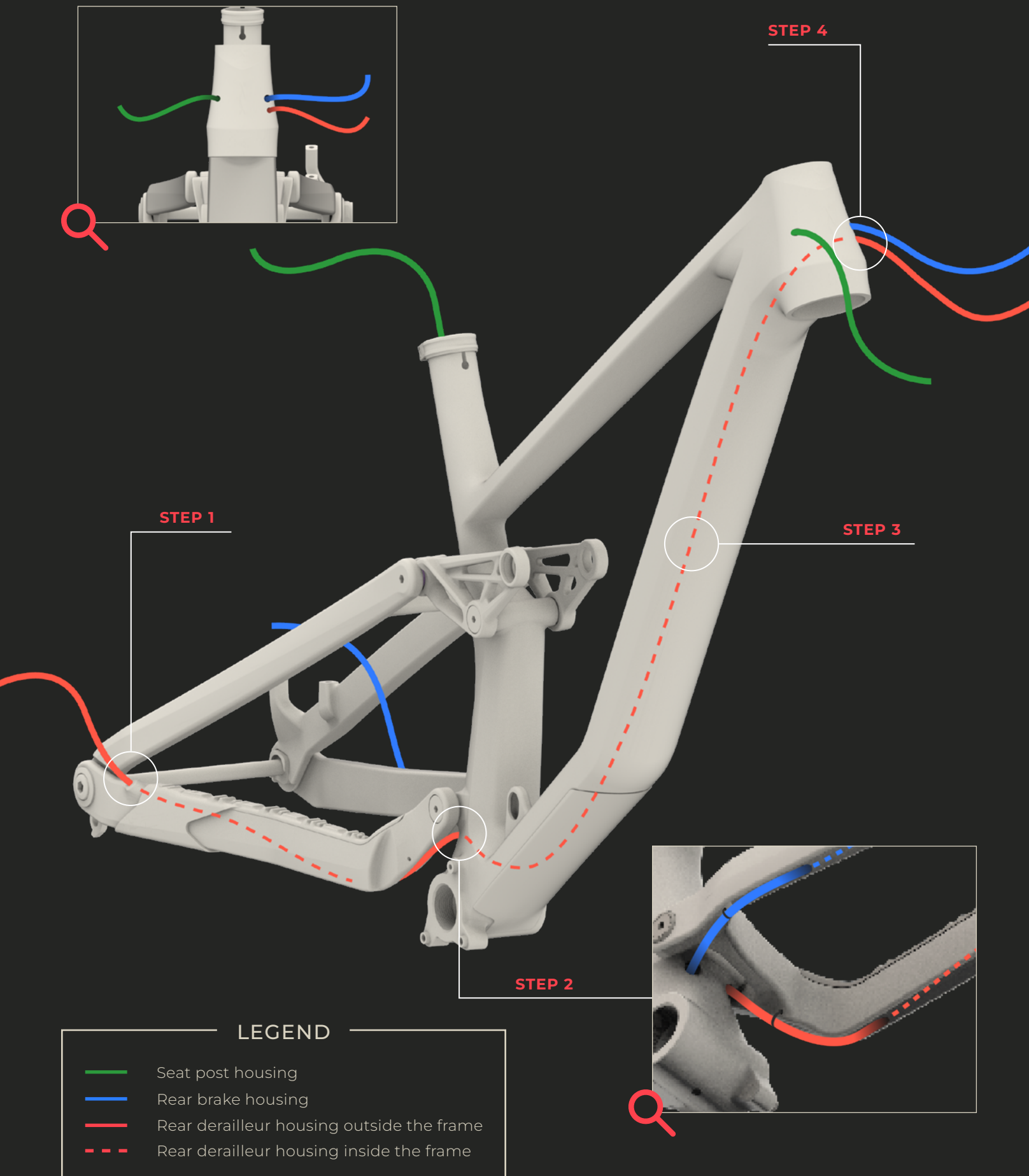

OVERVIEW

TROY CARBON

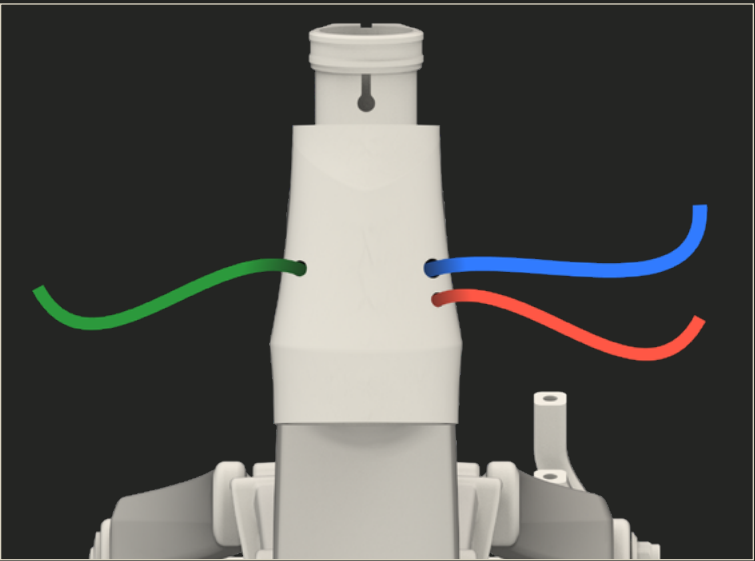
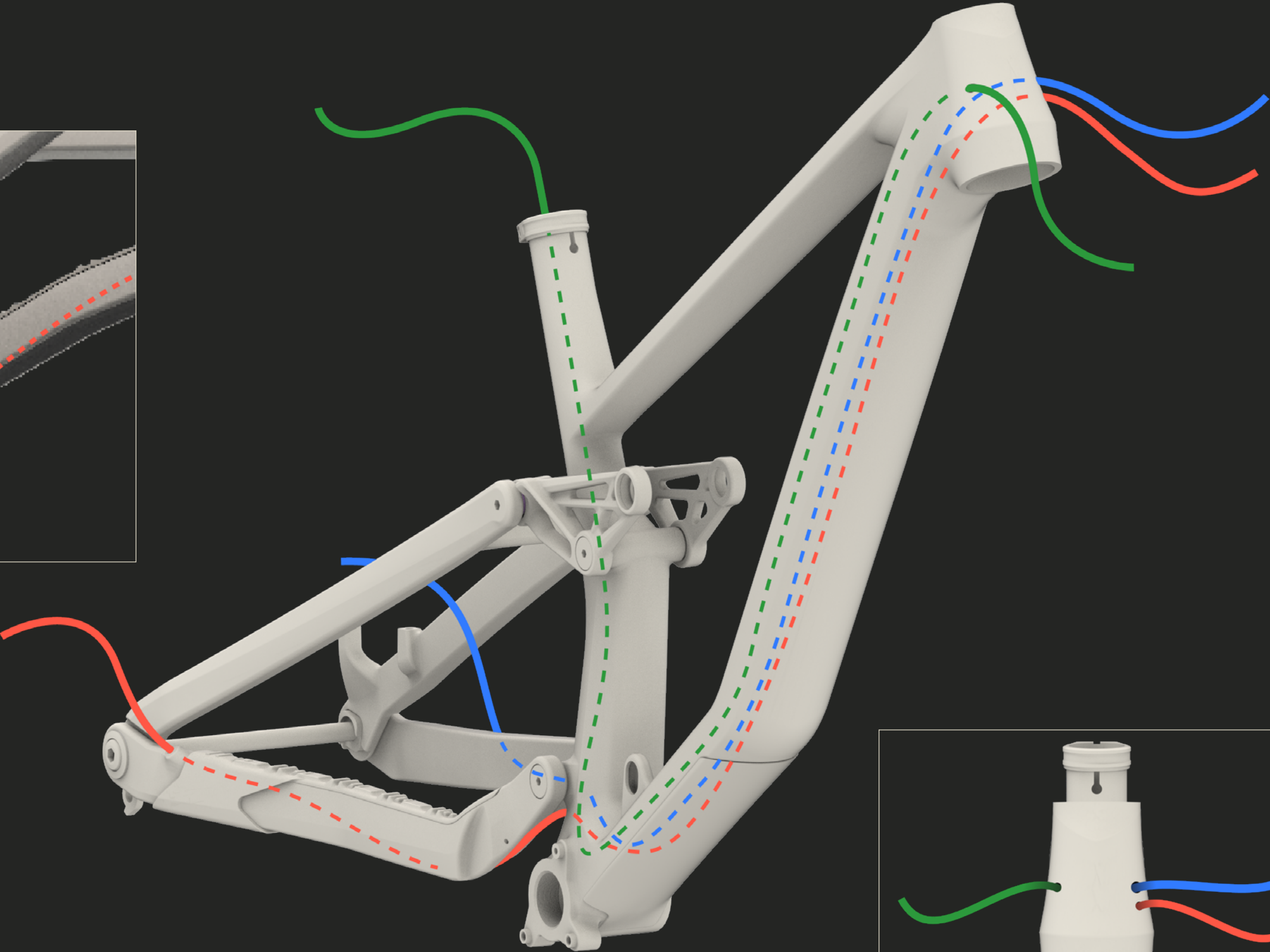
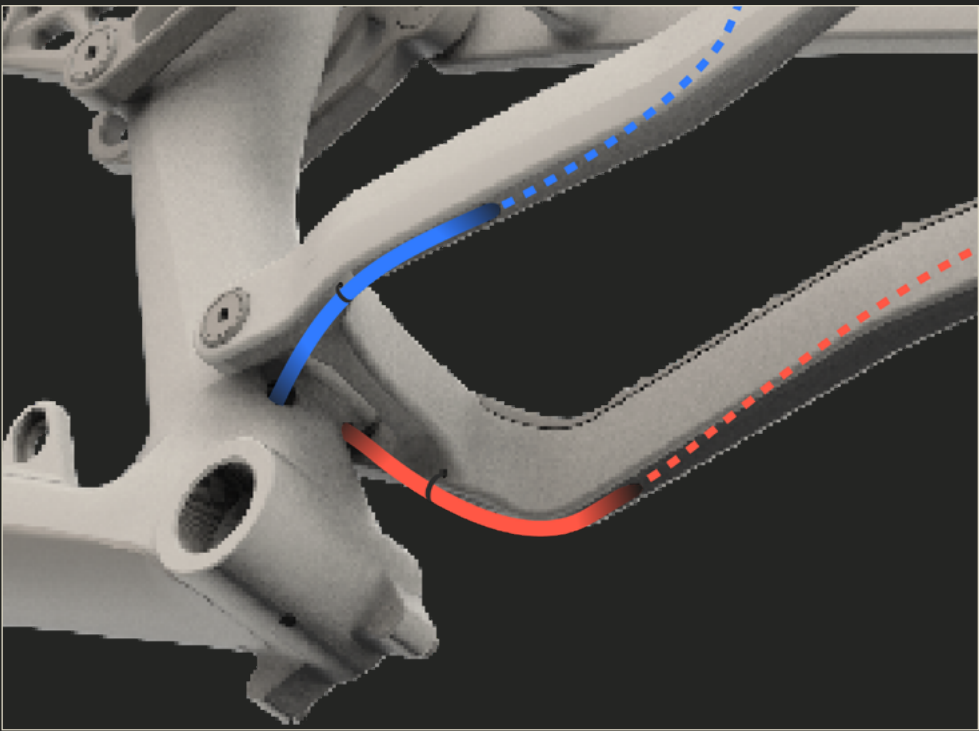

LEGEND

- Seatpost housing
- Rear brake housing
- Rear derailleur housing
- Housing outside the frame
- - - Housing inside the frame

SERVICE KITS



SERVICE KITS

TROY CARBON

KFC08902

BEARING KIT E-TROY LITE, TROY ST, TROY

ITEMS	PART #	DESCRIPTION	QTY
1	MFP21016	BALL BEARING MR20307 20x30x7; STD TYPE, DOUBLE LIP	2
2	MFP24014	BEARING 6900 WITH EXTENDED INNER CAGE	2
3	MFP19001	BALL BEARING 3801 LLU MAX 12x21x8	6

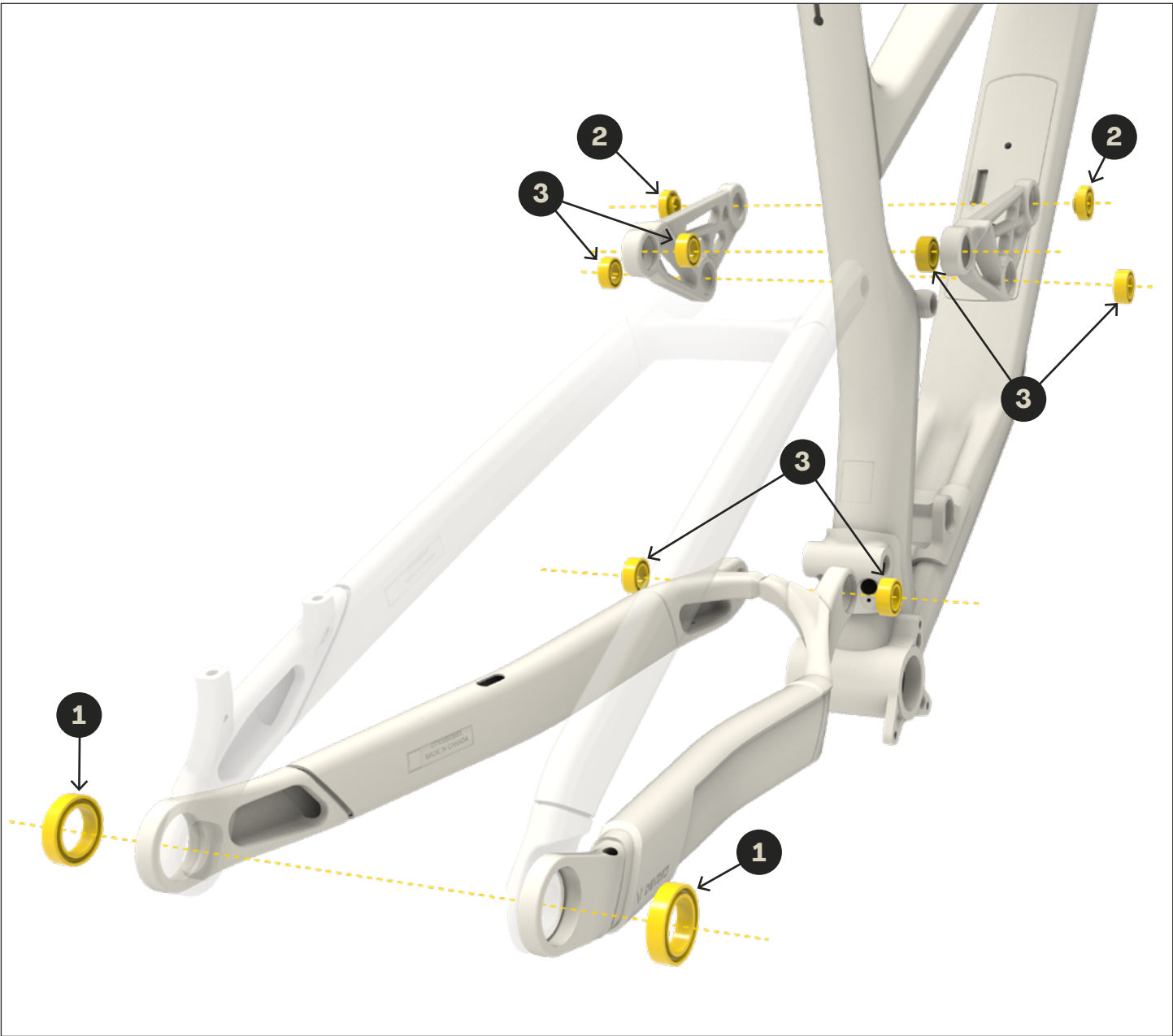

*THE FRAME IS FOR EXAMPLE ONLY.

KFC09001
SHOCK BOLT KIT TROY ST, TROY

ITEMS	PART #	DESCRIPTION	QTY
1	MFV24009	SOCKET CAP SCREW M10x1.0 X 16mm	2
2	MFP25008	ADJUSTER 5.5mm FOR 10mm SCREW	1
3	MFP25009	ADJUSTER 5.5mm M10x1.0	1
4	MFV25001	SOCKET CAP SCREW M10x1.0 X 59	1

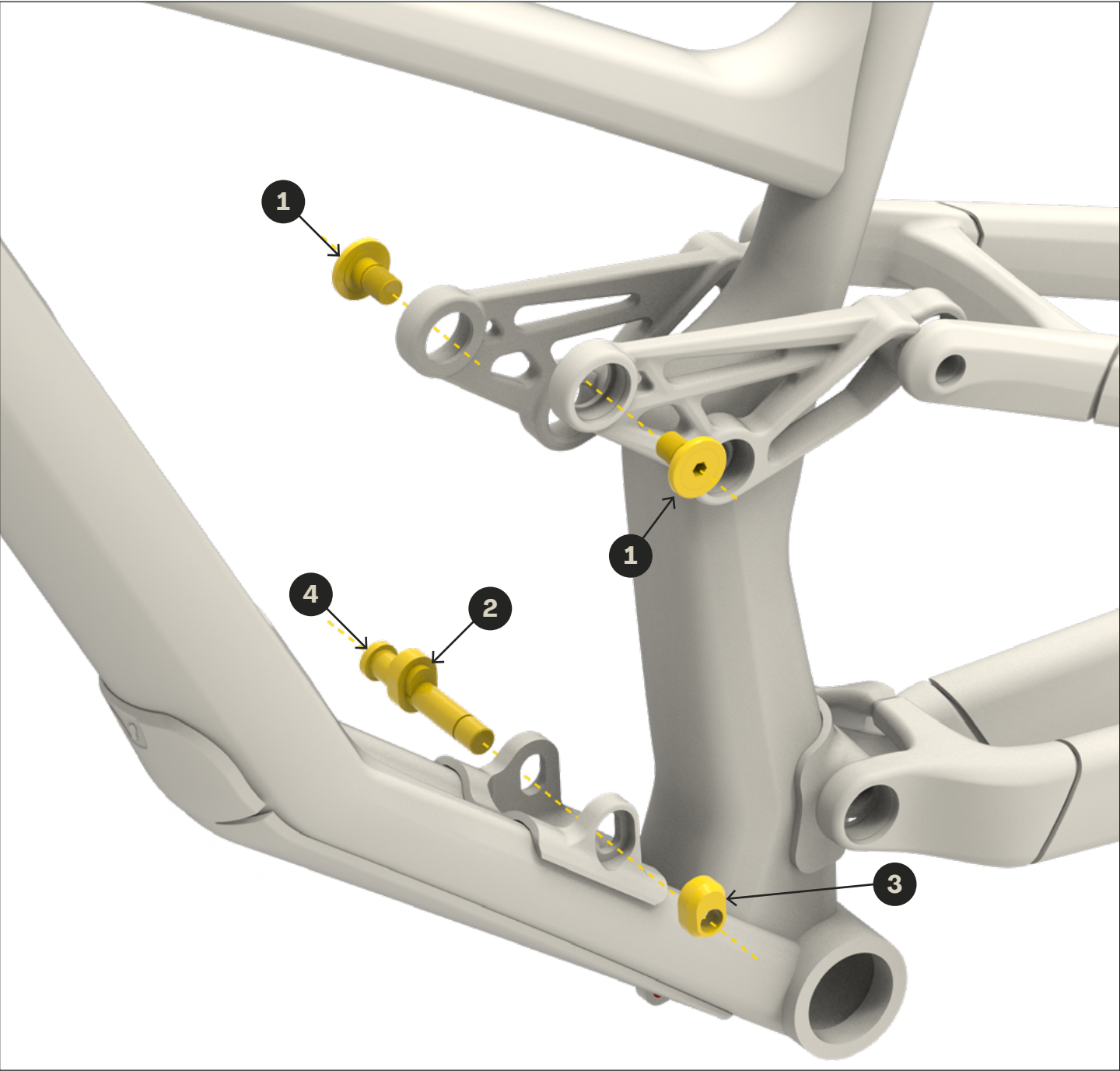

* THE FRAME IS FOR EXAMPLE ONLY.

KFC09002
PIVOT KIT TROY ST, TROY

ITEMS	PART #	DESCRIPTION	QTY
1	MFP24008	DROPOUT PIVOT LEFT SHAFT 20mm	1
2	MFD21001	HANGER UDH	1
3	MFP24009	PIVOT NUT FOR MR 20307 BEARING	1
4	MFV24016	SOCKET CAP SCREW M12x1.0 X 21mm	2
5	MFV24008	PIVOT WASHER	2
6	MFV24012	SOCKET FLAT SCREW M8x1.25 X 20m	2
7	MFP24010	SHAFT 12x73	2
8	MFP24012	PIVOT SPACER 12x16x4	2

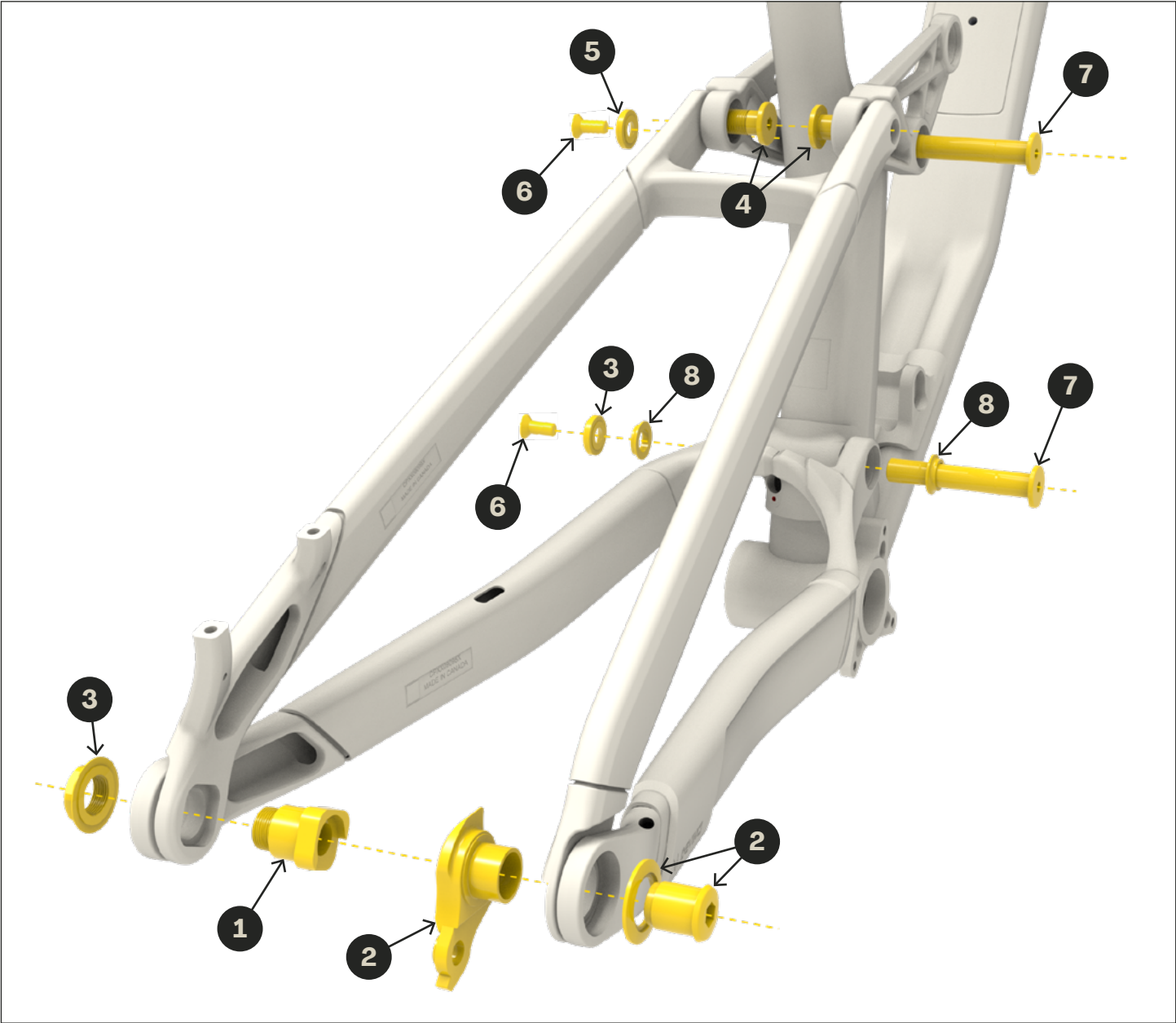

*THE FRAME IS FOR EXAMPLE ONLY.

KFC09003
CABLE GUIDE KIT TROY ST, TROY

ITEMS	PART #	DESCRIPTION	QTY
1	MFB19008	CABLE GUIDE 5mm	1
2	MFB25001	CABLE GUIDE FOR 081-090	2
3	MFV23016	ALLEN BUTTON SCREW M3x0.5 X 6mm	2

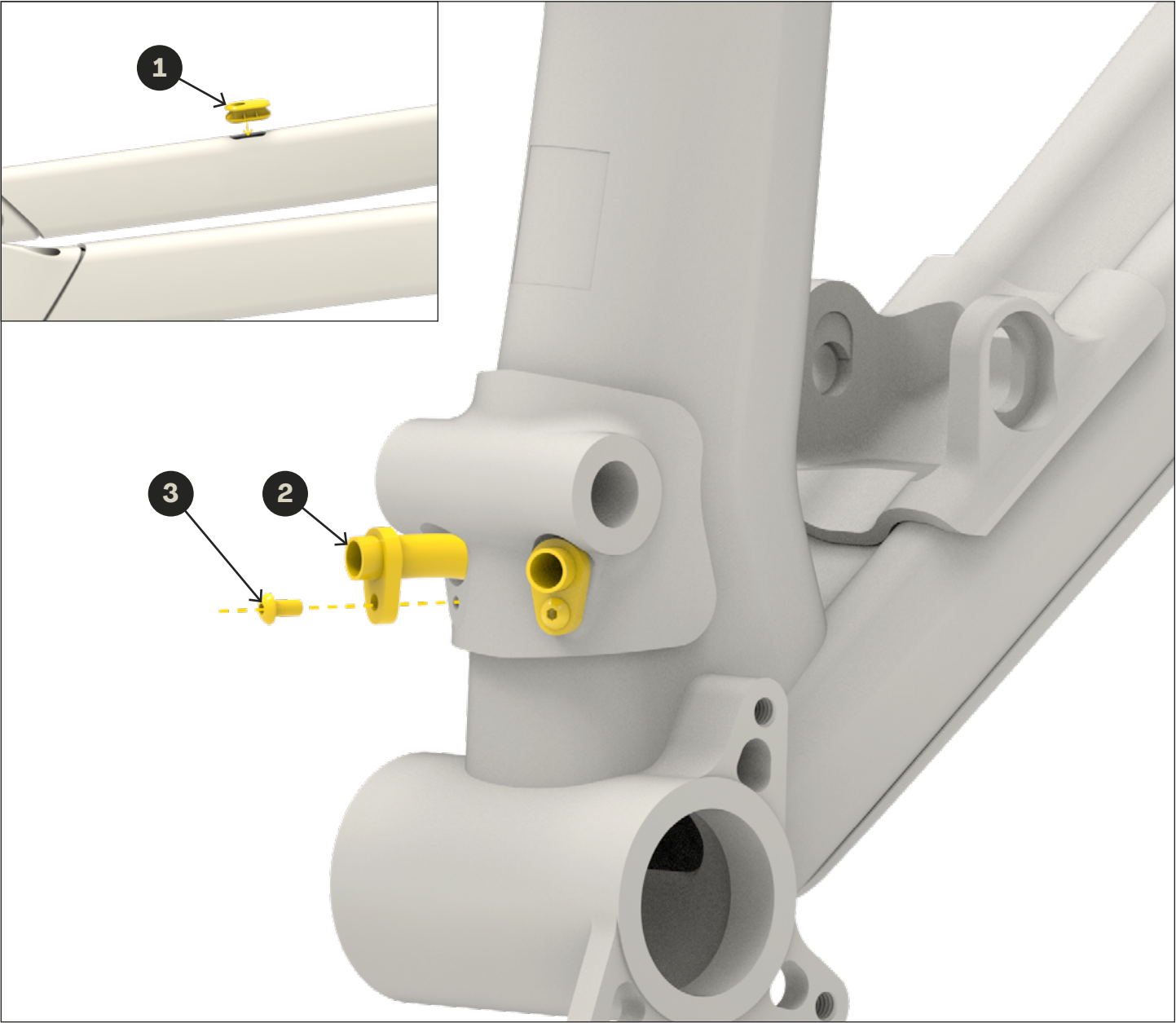

*THE FRAME IS FOR EXAMPLE ONLY.

KFC09102
KIT PROTECTORS DT+CS+SS, TROY CARBON

ITEMS	PART #	DESCRIPTION	QTY
1	MACP25003	CS PROTECTOR PCB-091	1
2	MACP25004	DT PROTECTOR PCB-091	1
3	MACP26002	091-SEATSTAY CHAIN PROTECTOR	1

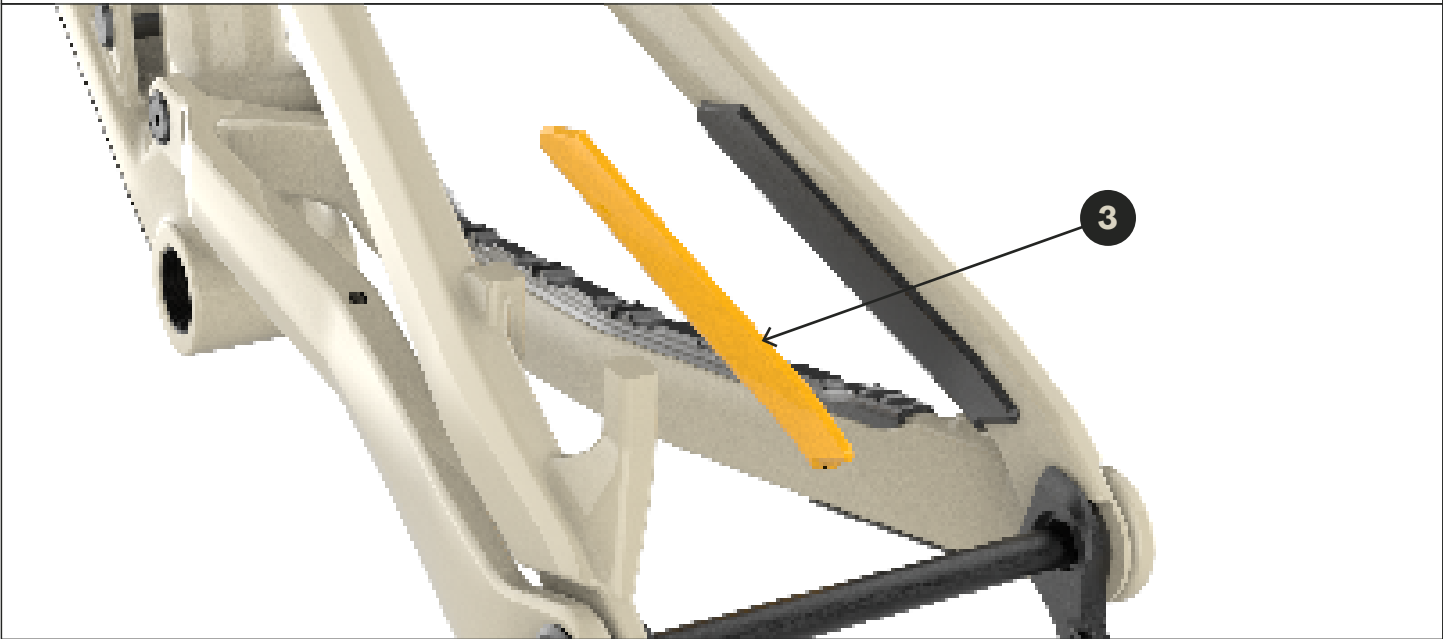

KFC05602
DERAILLEUR HANGER UDH W/29.7 WASHER SPLITPIVOT BIKES

ITEMS	PART #	DESCRIPTION	QTY
1	MFP21001	RD Hanger UDH	1

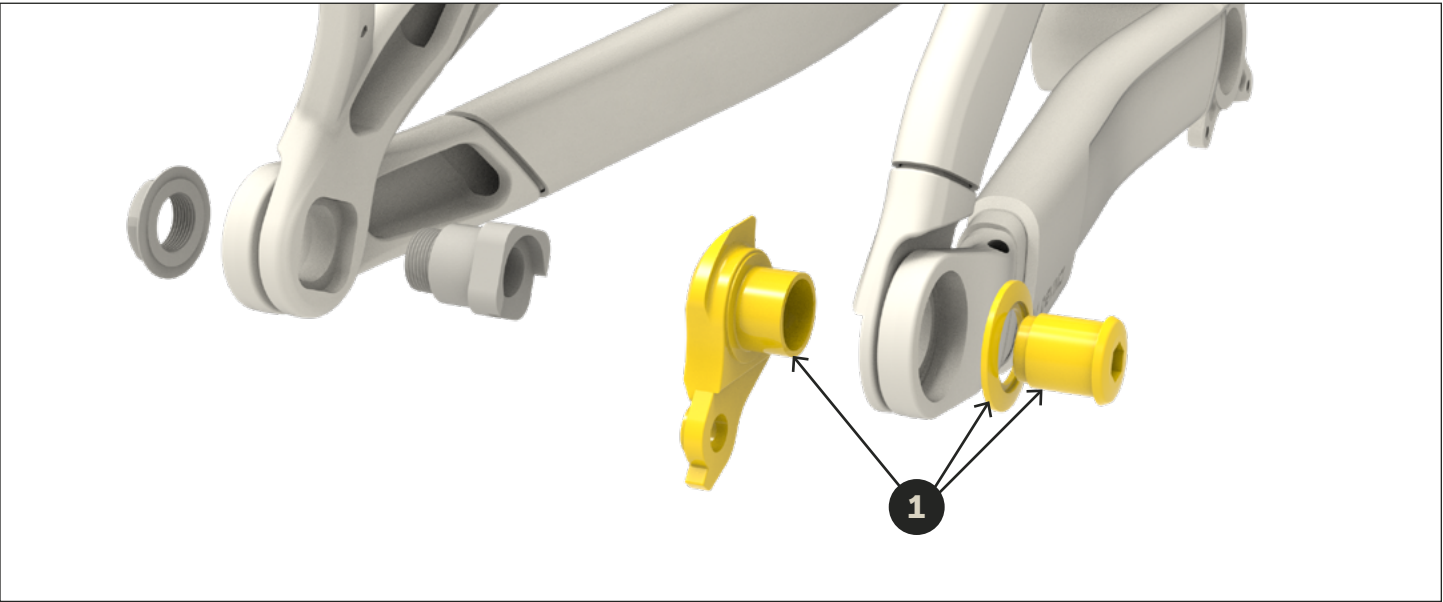

KFC06503
REAR AXLE BOOST 148*12MM UDH W/O HANDLE, SPLITPIVOT

ITEMS	PART #	DESCRIPTION	QTY
2	MATAR23002	Rear axle for 148mm UDH	1

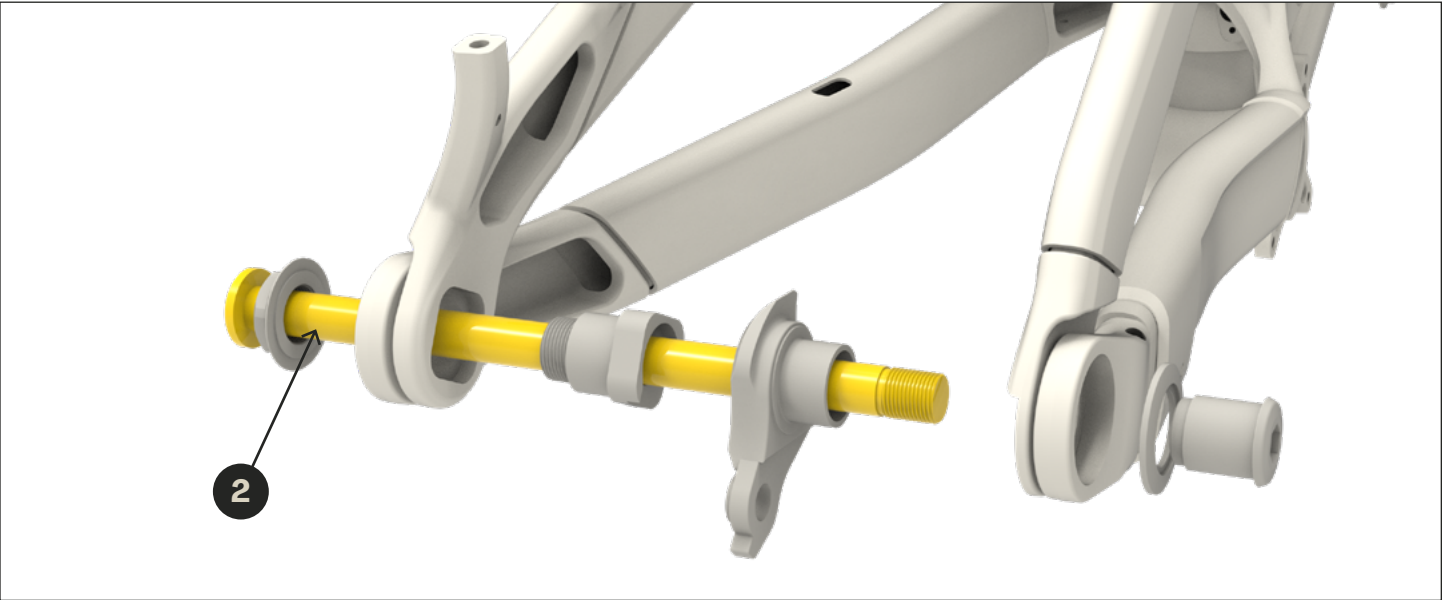

* THE FRAME IS FOR EXAMPLE ONLY.

KFC09006
THE SHED STORAGE ASSEMBLY, TROY ST, TROY

ITEMS	PART #	DESCRIPTION	QTY
1	MPAC24001	PORTE DE RANGEMENT ASSEMBLÉE	1
1.1	MFP24027	SYSTEM DOOR	1
1.2	MFP24028	MECANISM COVER	1
1.3	MFP24029	SYSTEM LOCK	1
1.4	MFV097132	FLAT HEAD THREAD FORMING SCREW FOR PLASTIC, #4 X 3/8"	2
1.5	MFV07003-01	ALLEN BUTTON SCREW M5x0.8 X 12	2
1.6	MFP24030	SYSTEM SEAL	1

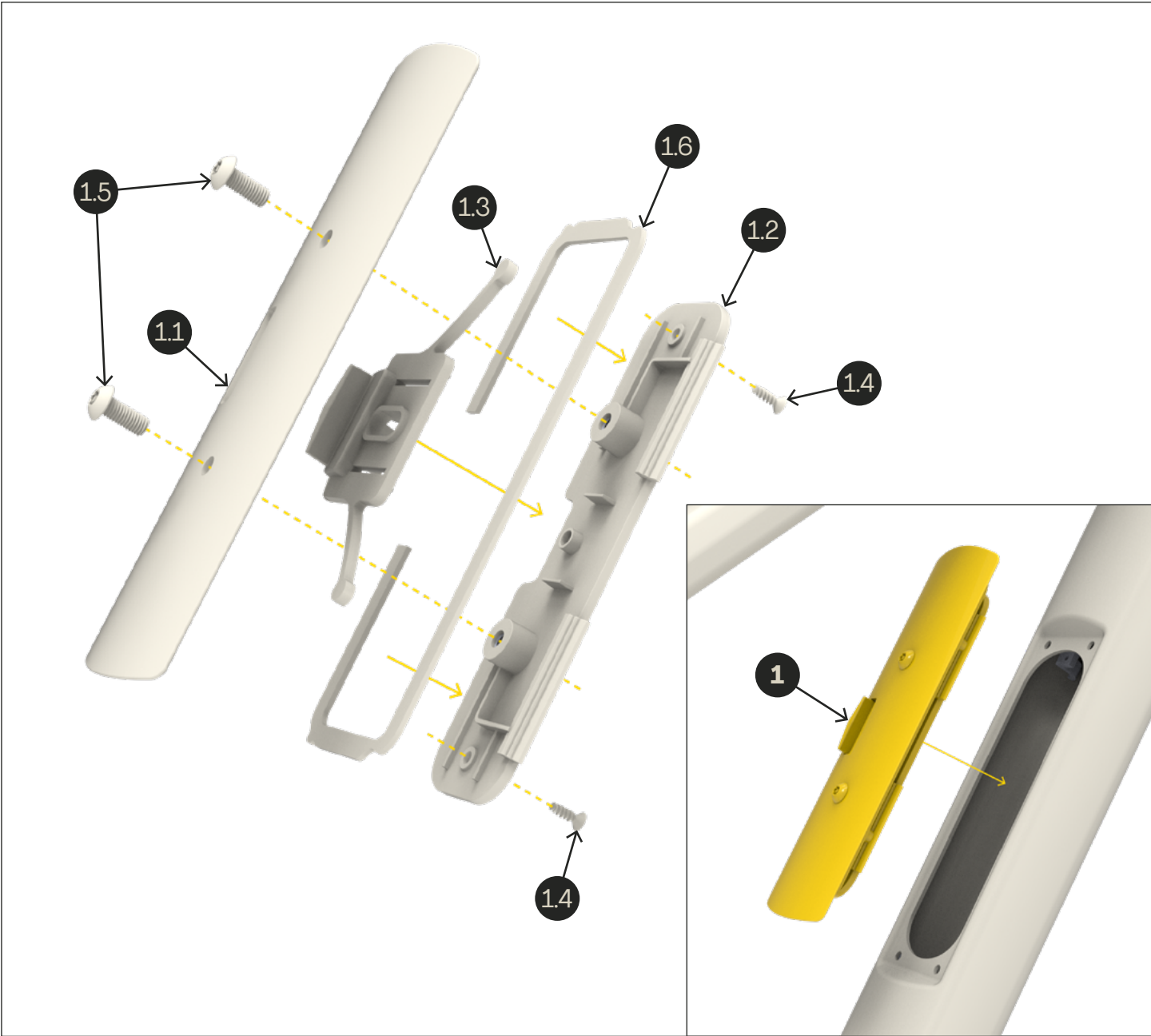

KFC09007
TOOL BAG FOR SHED STORAGE, TROY ST, TROY

ITEMS	PART #	DESCRIPTION	QTY
1	MFP24031	Tool bag	1



A full-page background image featuring a mountain biker in a blue long-sleeved shirt and black shorts, wearing a helmet, sitting on a black mountain bike. The biker is positioned on a mossy, rocky ridge. In the background, a large, rugged mountain peak is visible under a cloudy sky. Pine branches are visible in the foreground on the right side.

WARRANTY

DEVINCI WARRANTY



At Devinci, durability, performance, and peace of mind are at the core of everything we build. That’s why our warranty is designed to protect your investment and support you long after your purchase.

WHAT’S COVERED

FOR THE ORIGINAL OWNER

- **Aluminum frames:** Lifetime warranty* for the bicycle’s useful life
- **Carbon fiber frames:** Lifetime warranty* for the bicycle’s useful life
- **Paint and decals:** 1-year warranty
- **Suspension pivots (bearings, bolts, axles):** 1-year warranty

*Proof of purchase is required for all warranty claims.

COMPONENTS

All components on Devinci bikes are covered by their respective manufacturer warranties. For questions, your authorized Devinci retailer is your go-to resource. <https://www.devinci.com/en/find-a-dealer/>

OUTSIDE THE WARRANTY? WE’VE GOT YOUR BACK.

CUSTOMER ASSISTANCE PROGRAM

Accidents happen. That’s why we created the [Devinci Customer Assistance Program](#).

If your situation isn’t covered under warranty—whether it’s a crash, damage, or just bad luck—we’ll help you get back on the road or trail with a **discount on replacement parts**, based on their original retail price. This program is offered **for life**, at our discretion, and is available through our customer service team or any authorized Devinci retailer.

WHAT’S NOT COVERED

Our warranty does not apply in the following cases:

- Bike not purchased from an authorized Devinci retailer
- Improper assembly or service not performed by an authorized retailer
- Accidents, misuse, or excessive/abusive riding
- Damage from high-intensity use (racing, bike parks, improper transport, etc.)
- Structural or cosmetic modifications to the frame
- Normal wear and tear or material fatigue over time
- Costs of replacing parts that are worn out or obsolete at the time of the claim

For any questions, please contact our customer service team or your nearest Devinci retailer.

DEVINCI WARRANTY POLICY

All Devinci frames are covered by a manufacturer’s warranty against defects in materials and workmanship for a specified period, as detailed below, starting from the date of purchase. Any parts replaced or repaired under this warranty are covered for the remaining duration of the original warranty period.

The bicycle owner must provide proof of purchase to make a warranty claim.

Replacement parts are subject to availability within Devinci’s inventory at the time of the claim. In some cases, the color, features, and/or model may differ from the original part.

At Devinci’s discretion, certain costs may apply when processing a warranty replacement or repair, including:

- Shipping fees
- Additional labor costs associated with the installation or repair of a part
- Costs of replacing parts that are worn out or obsolete at the time of the claim

WARRANTY DURATION

For the original purchaser:

- Aluminum frames are covered for the lifetime of the bicycle’s useful life.
- Carbon fiber frames are covered for the lifetime of the bicycle’s useful life.
- Paint and decals are covered for one (1) year from the original date of purchase.
- Suspension frame pivots (including bearings, bolts, and axles) are covered for one (1) year from the original date of purchase.
- The components assembled on Devinci bicycles are exclusively covered by the warranties provided by their respective manufacturers, with Devinci assuming no responsibility. Please contact your authorized Devinci dealer for more details on applicable warranties.

CUSTOMER ASSISTANCE PROGRAM

For those unexpected moments when your situation is not covered under our warranty policy, Devinci’s Customer Assistance Program is here to help. Whether it’s a crash, accidental damage, or simple bad luck, this program is designed to get you back on the road or trails as quickly as possible by offering a discount on replacement parts based on their original retail price.

This program is separate from Devinci’s manufacturer warranty and is managed at Devinci’s sole discretion. It is accessible through our customer service department or any authorized Devinci retailer.

WARRANTY EXCLUSIONS

At Devinci’s discretion, the warranty may be void under the following circumstances:

- The bicycle was not purchased from an authorized Devinci retailer.
- The bicycle was not fully assembled by an authorized Devinci retailer.
- Repairs were not performed by an authorized Devinci retailer.
- The instructions in the user manual and/or technical manual were not followed.
- Recommended periodic inspections and maintenance outlined in the user manual and/or technical manual were not performed.
- Non-compatible parts were installed. Compatible parts include original components or those specified as compatible in the user manual and/or technical manual.
- Paint damage caused by the application or removal of an adhesive frame protector.

DEVINCI WARRANTY

- Damage resulted from accidental or unforeseen events, such as:
 - Accidents, impacts, or falls
 - Misuse, abnormal or excessive use, or negligence
 - Intensive use beyond the scope of normal recreational cycling
 - Improper or repeated use of ski lifts, vehicle racks, or other transportation methods
 - Use in competition or in environments/activities beyond the intended design of the bicycle
- Additional damage caused by continued use of the bicycle after an initial defect, if a warranty claim was not filed or was denied.
- The frame and/or components were altered (e.g., polishing, structural or mechanical modifications, stripping, sanding, shot peening, etc.).
- The frame size or model is inappropriate for the rider.
- Damage caused by normal wear and tear, including material fatigue over time.

LIMITATION OF LIABILITY

This warranty represents the complete and final warranty coverage for Devinci frames. Devinci does not authorize any individual, including authorized dealers, to offer any additional warranty beyond what is explicitly stated herein. Any other obligations, representations, or illustrations made by any party are not binding on Devinci and are excluded from this warranty.

Subject to applicable laws in Quebec and Canada, Devinci assumes no liability for material, bodily, or moral damages suffered by the user, purchaser, or any other party due to the use of a Devinci frame or component, except in cases of negligence or intentional misconduct by Devinci, as determined by a competent court.

Unless otherwise prohibited by applicable law, Devinci disclaims all other warranties, express or implied, including but not limited to implied warranties of merchantability or fitness for a particular purpose. Devinci's liability will not exceed the actual purchase price of the bicycle, nor will it cover any special, incidental, or consequential damages related to the bicycle.

By claiming warranty rights, the purchaser agrees that any legal proceedings shall be conducted in the judicial district of Chicoutimi, Province of Quebec, Canada.



1987



WE MAKE RIDERS

HEAD OFFICE

1555 Main
Chicoutimi (Quebec) Canada
G7K1G8

www.devinci.com